

Pre-insulating terminal

1

- The “D” range of terminals has been designed to meet the increasing demands for improved safety and reliability of electrical connectors
- Developed for use with production machinery, to give a quick and reliable crimped joint. The polycarbonate insulation, is a halogen free, self extinguishing thermoplastic material class VO[UL 94].
- The unique funnel shaped entry of the insulation sleeve. Guarantees total insertion of the conductor strands into the terminal barrel, creating a secure and reliable, electrical and mechanical connection.
- The maximum operating temperature is 115 (suge 130)
- The products have passed the Europea environment protection standard by SGS company.

Furcate pre-insulating terminal

Wire range:0.5-1.5mm²(A.W.G22-16) MAX AMP:1max=19A Material:Copper

Item no.	America wire	Bolt pass diameter d2(mm)	Dimension(mm)				Color	Thickness(mm)
			B	L	F	D		
DSV1.25-3	#4	3.2	5.7	21.2	6.5	4.3	Red	0.75
DSV1.25-3.5	#6	3.7	5.7	21.2	6.5			
DSV1.25-4	#8	4.3	6.4	21.2	6.5			
DSV1.25-5	#10	5.3	8.1	21.2	6.5			

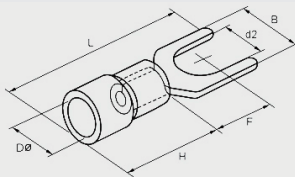

Wire range:1.5-2.5mm²(A.W.G16-14) MAX AMP:1max=27A Material:Copper

DSV2-3	#4	3.2	5.7	21.2	6.5	4.9	Blue	0.8
DSV2-3.5	#6	3.7	5.7	21.2	6.5			
DSV2-4	#8	4.3	6.4	21.2	6.5			
DSV2-5	#10	5.3	8.1	21.2	6.5			

Wire range:4-6mm²(A.W.G12-10) MAX AMP:1max=48A Material:Copper

DSV5.5-4	#8	4.3	8.3	25.2	7.5	6.7	Yellow	1
DSV5.5-5	#10	5.3	9	25.2	7.5			
DSV5.5-6	1	6.4	9	25.2	7.5			

Pin-shaped pre-insulating terminal

Wire range:0.5-1.5mm²(A.W.G22-16) MAX AMP:1max=19A Material:Copper

Item No.	Dimension(mm)				Color	Thickness(mm)
	F	L	H	D		
DPTV 1.25-10	1.9	20.0	10	4.3	Red	0.75
DPTV 1.25-12	1.9	22.0	12			
DPTV 1.25-18	1.9	28.0	18			

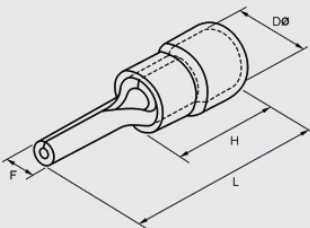

Wire range:1.5-2.5mm²(A.W.G16-14) MAX AMP:1max=27A Material:Copper

DPTV 2-10	1.9	20.0	10	4.9	Blue	0.8
DPTV 2-12	1.9	22.0	12			
DPTV 2-18	1.9	28.0	18			

Wire range:4-6mm²(A.W.G12-10) MAX AMP:1max=48A Material:Copper

DPTV 5.5-13	2.8	25.5	13	6.7	Yellow	1.0
-------------	-----	------	----	-----	--------	-----

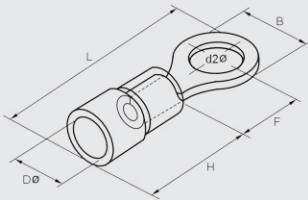
**Circular pre-insulating terminal**Wire range:0.5~1.5mm²(A.W.G22-16) MAX AMP:1max=19A Material:Copper Tickness:0.75mm

Item no.	America wire	Bolt pass diameter d2(mm)	Dimension(mm)					Color
			B	L	F	H	DΦ	
DRV 1.25-3	#4	3.2	5.7	17.8	4.95	10	4.3.	Red
DRVS 1.25-3.5	#6	3.7	5.7	17.8	4.95			
DRVM 1.25-3.5	#6	3.7	6.6	20.1	6.3			
DRVL 1.25-3.5	#6	4.3	8	21.5	7			
DRVS 1.25-4	#8	4.3	6.6	20.1	6.3			
DRVL 1.25-4	#8	4.3	8	21.5	7			
D 1.25-5	#10	5.3	8	21.5	7			
DRVL 1.25-5	#10	5.3	9.8	23	8.5			
DRVS 1.25-6	1/4	6.4	9.8	23	8.5			
DRV 1.25-6	1/4	6.4	11.6	27.5	11.1			
DRV 1.25-8	5/16	8.1	11.6	27.5	11.1			
DRV 1.25-10	3/8	10.5	13.6	31.6	13.9			
DRV 1.25-12	1/2	13	19.2	36	16.5			

Wire range:1.5~2.5mm²(A.W.G16-14) MAX AMP:1max=27A Material:Copper Tickness:0.8mm

DRV 2-3	#4	3.2	6.6	17.8	4.3	10	4.9	Blue
DRVS 2-3.5	#6	3.7	6.6	17.8	4.3			
DRVM 2-3.5	#6	3.7	6.6	20.1	7.0			
DRVL 2-3.5	#6	3.7	8.5	22.5	7.75			
DRVS 2-4	#8	4.3	6.6	21.0	7.0			
DRVL 2-4	#8	4.3	8.5	22.5	7.75			
DRV 2-5	#10	5.3	8.5	22.5	7.75			
DRVL 2-5	#10	5.3	9.5	22.5	7.25			
DRV 2-6	1/4	6.4	12.0	27.6	11.0			
DRV 2-8	5/16	8.1	12.0	27.6	11.0			
DRV 2-10	3/8	10.5	13.6	30.2	13.9			
DRV 2-12	1/2	13.0	19.2	36.5	16.5			

Wire range:2.5~4mm²(A.W.G14-12) MAX AMP:1max=37A Material:Copper Tickness:1.0mm

DRV 3.5-4	#8	4.3	8.0	24.5	7.7	13	6.2	Black
DRVS 3.5-5	#10	5.3	8.0	24.5	7.7			
DRVL 3.5-5	#10	5.3	12.0	27.9	7.7			
DRV 3.5-6	1/4	6.4	12.0	27.9	7.7			

Wire range:4~6mm²(A.W.G12-10) MAX AMP:1max=48A Material:Copper Tickness:1.0mm

DRV 5.5-3.5	#6	3.7	7.2	21.4	5.9	13	6.7	Yellow
DRVS 5.5-4	#8	4.3	7.2	21.4	5.9			
DRVL 5.5-4	#8	4.3	9.5	25.5	8.3			
DRV 5.5-5	#10	5.3	9.5	25.5	8.3			
DRV 5.5-6	1/4	6.4	12	31.5	13			
DRV 5.5-8	5/16	8.4	15	33.7	13.7			
DRV 5.5-10	3/8	10.5	15	33.7	13.7			
DRV 5.5-12	1/2	13	19.2	38.1	16			

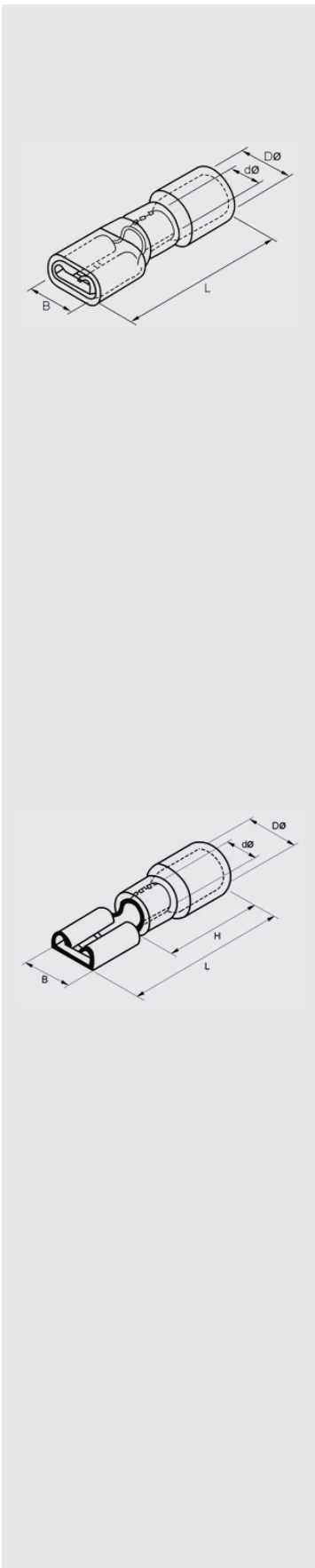

Female full-insulating joint

Wire range:0.5~1.5mm²(A.W.G22-16) MAX AMP:1max=10A Material:Brass

Item no.	Name tab(mm)	Dimension(mm)			
		B	D Φ	d Φ	L
DFDFD 1.25-187(5)	0.5x4.75	5.6	3.8	1.7	20
DFDFD 1.25-187(8)	0.8x4.75	5.6	3.8	1.7	20
DFDFD 1.25-250	0.8x6.35	7.4	3.8	1.7	21.5

Wire range:1.5~2.5mm²(A.W.G16-14) MAX AMP:1max=15A Material:Brass

DFDFD 2-187(5)	0.8x4.75	5.6	4.3	2.3	20
DFDFD 2-187(8)	0.8x4.75	5.6	4.3	2.3	20
DFDFD 2-250	0.8x6.35	7.4	4.3	2.3	21.5

Wire range:4~6mm²(A.W.G12-10) MAX AMP:1max=24A Material:Brass

DFDFD 5.5-250	0.8x6.35	7.4	5.7	3.4	25.5
---------------	----------	-----	-----	-----	------

Female full-insulating joint

Wire range:0.5~1.5mm²(A.W.G22-16) MAX AMP:1max=19A Material:Brass

Item no.	Name tab(mm)	Thickness of material	Dimension(mm)					Color
			B	D Φ	d Φ	L	H	
DFDD 1.25-110(5)	0.5 2.8	0.3	3.8	3.8	1.7	19	10	Rad
DFDD 1.25-110(8)	0.8 2.8	0.3	3.8	3.8	1.7	19	10	
DFDD 1.25-187(5)	0.5 4.75	0.35	5.6	3.8	1.7	19	10	
DFDD 1.25-187(8)	0.8 4.75	0.35	5.6	3.8	1.7	19	10	
DFDD 1.25-205	0.5 5.2	0.35	6.5	3.8	1.7	20	10	
DFDD 1.25-250	0.8 6.35	0.4	7.4	3.8	1.7	21	10	

Wire range:1.5~2.5mm²(A.W.G16-14) MAX AMP:1max=15A Material:Brass

Item no.	Name tab(mm)	Thickness of material	Dimension(mm)					Color
			B	D Φ	d Φ	L	H	
DFDD 2-110(5)	0.5 2.8	0.3	3.8	4.3	2.3	19	10	Bule
DFDD 2-110(8)	0.8 2.8	0.3	3.8	4.3	2.3	19	10	
DFDD 2-187(5)	0.5 4.75	0.35	5.6	4.3	2.3	19	10	
DFDD 2-187(8)	0.8 4.75	0.35	5.6	4.3	2.3	19	10	
DFDD 2-205	0.5 5.2	0.35	6.5	4.3	2.3	20	10	
DFDD 2-250	0.8 6.35	0.4	7.4	4.3	2.3	21	10	
DFDD 2-312	0.8 8.0	0.4	9	4.3	2.3	23	10	

Wire range:4~6mm²(A.W.G12-10) MAX AMP:1max=24A Material:Brass

Item no.	Name tab(mm)	Thickness of material	Dimension(mm)					Color
			B	D Φ	d Φ	L	H	
DFDD 5.5-250	0.8 6.35	0.4	7.4	5.7	3.4	25	13	Yellow
DFDD 5.5-375	1.2 9.4	0.5	10.9	5.7	3.4	29.6	13	

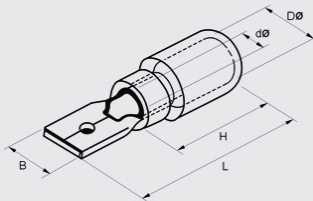

Female full-insulating joint

Wire range:0.5~1.5mm²(A.W.G22-16) MAX AMP:1max=10A Material:Brass

Item no.	Name tab(mm)	Thickness of material	Dimension(mm)					Color
			B	dΦ	DΦ	L	H	
DMDD 1.25-110(5)	0.5 2.8	0.5	2.8	1.7	4.3	17.7	10	Rad
DMDD 1.25-110(8)	0.8 2.8	0.8	2.8	1.7	4.3	17.7	10	
DMDD 1.25-187(5)	0.5 4.75	0.5	4.75	1.7	4.3	20	10	
DMDD 1.25-187(8)	0.8 4.75	0.8	4.75	1.7	4.3	20	10	
DMDD 1.25-250	0.8 6.35	0.4 2	6.35	1.7	4.3	21	10	

Wire range:1.5~2.5mm²(A.W.G16-14) MAX AMP:1max=15A Material:Brass

Item no.	Name tab(mm)	Thickness of material	Dimension(mm)					Color
			B	dΦ	DΦ	L	H	
DMDD 2-187(5)	0.5 4.75	0.5	4.75	2.3	4.3	20	10	Bule
DMDD 2-187(8)	0.8 4.75	0.8	4.75	2.3	4.3	20	10	
DMDD 2-250	0.8 6.35	0.4 2	6.35	2.3	4.3	21	10	

Wire range:4~6mm²(A.W.G12-10) MAX AMP:1max=24A Material:Brass

Item no.	Name tab(mm)	Thickness of material	Dimension(mm)					Color
			B	dΦ	DΦ	L	H	
DMDD 5.5-250	0.8 6.35	0.4 2	6.35	3.4	5.7	25	13	Yellow

Hooked pre-insulating joint

Conductor section:0.5-1.5mm²(A.W.G22-16) I_{max}=19A Material:Copper Thickness:0.75mm

Item no.	Dimension(mm)					Color
	B	L	F	H	DΦ	
LBV 1.25-3	3	26.8	16.8	10.0	4.3	Rad
LBV 1.25-4.6	4.6	26.8	16.8			

Conductor section:0.5-1.5mm²(A.W.G22-16) I_{max}=19A Material:Copper Thickness:0.75mm

Item no.	Dimension(mm)					Color
	B	L	F	H	DΦ	
LBV 2-3	3	26.8	16.8	10.0	4.9	Blue
LBV 2-4.6	4.6	26.8	16.8			

Conductor section:0.5-1.5mm²(A.W.G22-16) I_{max}=19A Material:Copper Thickness:0.75mm

Item no.	Dimension(mm)					Color
	B	L	F	H	DΦ	
LBV 5.5-3	3	29.3	16.8	13	6.7	Yellow
LBV 5.5-4.6	4.6	29.3	16.8			

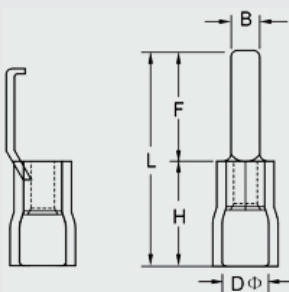
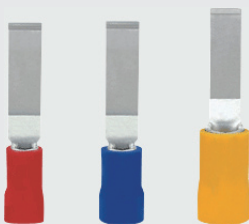

Female full-insulating joint

Conductor section:0.5~1.5mm²(A.W.G22-16) I_{max}=19A Material:Copper Thickness:0.75mm

Item no.	American boit number	d2(mm)	Dimension(mm)					Color
			B	L	F	H	D Φ	
SV 1.25-3	#4	3.2	5.7	21.2	6.5	10	4.3	Rad
SVS 1.25-3.5	#6	3.7	5.7	21.2	6.5			
SVL 1.25-3.5	#6	3.7	6.4	21.2	6.5			
SVS 1.25-4	#8	4.3	6.4	21.2	6.5			
SVM 1.25-4	#8	4.3	7.2	21.2	6.5			
SVL 1.25-4	#8	4.3	8.1	21.2	6.5			
SVS 1.25-5	#10	5.3	8.1	21.2	6.5			
SVL 1.25-5	#10	5.3	9.5	21.2	6.5			
SVS 1.25-6	1/4	6.4	9.5	21.2	6.5			
SVL 1.25-6	1/4	6.4	12	27.2	11			

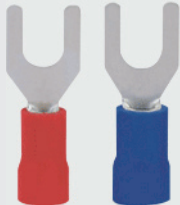

Conductor section:1.5~2.5mm²(A.W.G16-14) I_{max}=27A Material:Copper Thickness:0.8mm

Item no.	American boit number	d2(mm)	Dimension(mm)					Color
			B	L	F	H	D Φ	
SV 2-3	#4	3.2	5.7	21.2	6.5	10	4.9	Blue
SVS 2-3.5	#6	3.7	5.7	21.2	6.5			
SVL 2-3.5	#6	3.7	6	21.2	6.5			
SVS 2-4	#8	4.3	6.4	21.2	6.5			
SVM 2-4	#8	4.3	7.2	21.2	6.5			
SVL 2-4	#8	4.3	8.1	21.2	6.5			
SVS 2-5	#10	5.3	8.1	21.2	6.5			
SVL 2-5	#10	5.3	9.5	21.2	6.5			
SVS 2-6	1/4	6.4	9.5	21.2	6.5			
SVL 2-6	1/4	6.4	12	27.2	11			



Conductor section:2.5~4mm²(A.W.G14-12) I_{max}=37A Material:Copper Thickness:1.0mm

Item no.	American boit number	d2(mm)	Dimension(mm)					Color
			B	L	F	H	D Φ	
SV 3.5-3	#4	3.2	5.7	24.8	7	13	6.2	Black
SV 3.5-4	#8	4.3	8	24.8	7			
SV 3.5-5	#10	5.3	8	24.8	7			
SV 3.5-6	1/4	6.4	12	28	12.1			
SV 3.5-8	16-5	8.4	12	33.7	13.7			

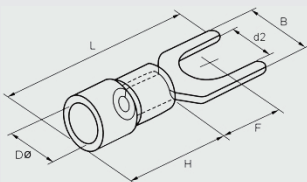

Conductor section:4~6mm²(A.W.G12-10) I_{max}=48A Material:Copper Thickness:1.0mm

Item no.	American boit number	d2(mm)	Dimension(mm)					Color
			B	L	F	H	D	
SV 5.5-3.5	#6	3.7	8.3	25.2	7.5	13	6.7	Yellow
SVS 5.5-4	#8	4.3	8.3	25.2	7.5			
SVL 5.5-4	#8	4.3	9	25.2	7.5			
SV 5.5-5	#10	5.3	9	25.2	7.5			
SVS 5.5-6	1/4	6.4	9	25.2	7.5			
SVL 5.5-6	1/4	6.4	12	31.2	12			
SV 5.5-8	5/16	8.4	14	30	11.5			

1

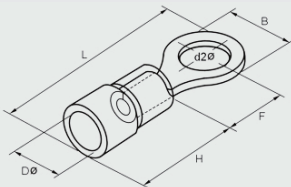

Circular pre-insulating terminal(TYPE TO-JTK)

Conductor section:0.5~1.5mm²(A.W.G22-16) I_{max}:=19A Material:Copper Thickness:0.75mm

Item no.	American boit number	d2(mm)	Dimension(mm)					Color
			B	L	F	H	D Φ	
RV 1.25-3	#4	3.2	5.7	17.8	4.95	10	4.3	Rad
RVS 1.25-3.5	#6	3.7	5.7	17.8	4.95			
RVM 1.25-3.5	#6	3.7	6.6	20.1	6.3			
RVL 1.25-3.5	#6	4.3	8	21.5	7			
RVS 1.25-4	#8	4.3	6.6	20.1	6.3			
RVL 1.25-4	#8	4.3	8	21.5	7			
RV 1.25-5	#10	5.3	8	21.5	7			
RVL 1.25-5	#10	5.3	9.8	23	8.5			
RVS 1.25-6	1/4	6.4	9.8	23	8.5			
RV 1.25-6	1/4	6.4	11.6	27.5	11.1			
RV 1.25-8	5/16	8.1	11.6	27.5	11.1			
RV 1.25-10	3/8	10.5	13.6	31.6	13.9			
RV 1.25-12	1/2	13	19.2	36	16.5			

Conductor section:1.5~2.5mm²(A.W.G16-14) I_{max}:=27A Material:Copper Thickness:0.8mm

Item no.	American boit number	d2(mm)	Dimension(mm)					Color
			B	L	F	H	D Φ	
RV 2-3	#4	3.2	6.6	17.8	4.3	10	4.9	Blue
RVS 2-3.5	#6	3.7	6.6	17.8	4.3			
RVM 2-3.5	#6	3.7	6.6	20.1	7			
RVL 2-3.5	#6	3.7	8.5	22.5	7.75			
RVS 2-4	#8	4.3	6.6	21	7			
RVL 2-4	#8	4.3	8.5	22.5	7.75			
RV 2-5	#10	5.3	8.5	22.5	7.75			
RVL 2-5	#10	5.3	9.5	22.5	7.25			
RV 2-6	1/4	6.4	12	27.6	11			
RV 2-8	5/16	8.1	12	27.6	11			
RV 2-10	3/8	10.5	13.6	30.2	13.9			
RV 2-12	1/2	13	19.2	36.5	16.5			

Conductor section:2.5~4mm²(A.W.G14-12) I_{max}:=37A Material:Copper Thickness:1.0mm

Item no.	American boit number	d2(mm)	Dimension(mm)					Color
			B	L	F	H	D Φ	
RV 3.5-4	#8	4.3	8	24.5	7.7	13	6.2	Black
RVS 3.5-5	#10	5.3	8	24.5	7.7			
RVL 3.5-5	#10	5.3	12	27.9	7.7			
RV 3.5-6	1/4	6.4	12	27.9	7.7			

Conductor section:4~6mm²(A.W.G12-10) I_{max}:=48A Material:Copper Thickness:1.0mm

Item no.	American boit number	d2(mm)	Dimension(mm)					Color
			B	L	F	H	D	
RV 5.5-3.5	#6	3.7	7.2	21.4	5.9	13	6.7	Yellow
RVS 5.5-4	#8	4.3	7.2	21.4	5.9			
RVL 5.5-4	#8	4.3	9.5	25.5	8.3			
RV 5.5-5	#10	5.3	9.5	25.5	8.3			
RV 5.5-6	1/4	6.4	12	31.5	13			
RV 5.5-8	5/16	8.4	15	33.7	13.7			
RV 5.5-10	3/8	10.5	15	33.7	13.7			
RV 5.5-12	1/2	13	19.2	38.1	16			

Tube pre-insulating terminal(TYPE TG-JT)

Umax:105°C Ui=300V Material:Copper Insulating Material:Nylon

Item no.	Dimension(mm)						mm2	Color of insulationsheath	
	F	L	W	DΦ	CΦ	A.W.G		(Top)Germany	(Bottom)France
E 0506	6	12	2.5	1.3	1	# 22	0.5	Orange	
E 0508	8	14							
E 0510	10	16							
E 0512	12	18							
E 7506	6	12.4	2.8	1.5	1.2	# 20	0.75	White	
E 7508	8	14.6							
E 7510	10	16.4							
E 7512	12	18.4							
E 1006	6	12.4	3	1.7	1.4	# 18	1	Yellow	
E 1008	8	14.6							
E 1010	10	16.4							
E 1012	12	18.4							
E 1508	8	14.6	3.5	2	1.7	# 16	1.5	Rad	
E 1510	10	16.4							
E 1512	12	18.4							
E 1518	18	24.4							
E 2508	8	15.2	4	2.6	2.3	# 14	2.5	Blue	
E 2510	10	17.2							
E 2512	12	19.2							
E 2518	18	25.2							
E 4009	9	16.5	4.4	3.2	2.8	# 12	4	Gray	
E 4012	12	19.5							
E 4018	18	25.5							
E 6010	10	18	6.3	3.9	3.5	# 10	6	Black	
E 6012	12	20							
E 6018	18	26							
E 10-12	12	21.5	7.6	4.9	4.5	# 7	10	Lvory	
E 10-18	18	27.5							
E 16-12	12	22.2	8.8	6.2	5.8	# 5	16	Green	
E 16-18	18	28.2							
E 25-16	16	29	11.2	7.9	7.5	# 4	25	Brown	
E 25-22	22	35							
E 35-16	16	30	12.7	8.7	8.3	# 2	35	Dust-colour	
E 35-25	25	39							
E 50-20	20	36	15.3	10.9	10.3	# 1	50	Olives color	
E 50-25	25	41							

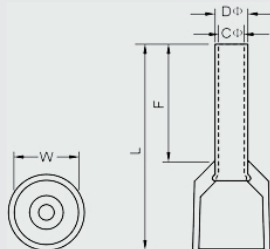

1

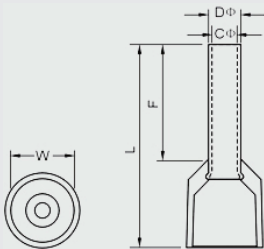

Crewel tube pre-insulating terminal

U_{max}:105°C U_i=300V Material:Copper Pipe Insulating Cover Material:Nylon

Item no.	Conductor (mm ²)	Dimension(mm)						Color	
		F	L	W	B	DΦ	CΦ	German	French
TE 0508	2 0.5	8	14.5	5	6.5	1.8	1.5	White	White
TE 7508	2 0.75	8	14.7	5.5	6.7	2.1	1.8	Blue	Gray
TE 7510	2 0.75	10	16.7	5.5	6.7	2.1	1.8		
TE 1008	2 1.0	8	15.1	5.5	7.1	2.3	2	Rad	Rad
TE 1010	2 1.0	10	17.1	5.5	7.1	2.3	2		
TE 1508	2 1.5	8	15.5	6.4	7.2	2.6	2.3	Black	blue
TE 1512	2 1.5	12	19.5	6.4	7.5	2.6	2.3		
TE 2510	2 2.5	10	18.5	8	8.5	3.3	2.9	Gray	Blue
TE 2513	2 2.5	13	21.5	8	8.5	3.3	2.9		
TE 4012	2 4.0	12	23.1	8.8	11.1	4.2	3.8	Orange	Gray
TE 6014	2 6.0	14	26.1	9.5	12.1	5.3	4.9	Green	Yellow
TE 10-14	2 10.0	14	26.6	12.6	12	6.9	6.5	Brown	Rad
TE 16-14	2 16.0	14	31.3	19	17.3	8.7	8.3	Lvory	Blue

Female pre-insulating joint

Conductor section:0.5-1.5mm²(A.W.G22-16) I_{max}=10A Material:Brass

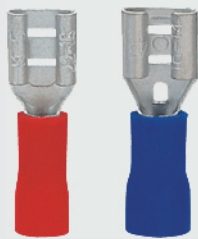

Item no.	Name tab (mm)	Thickness of material	Dimension(mm)					Color
			B	DΦ	dΦ	L	H	
FDD 1.25-110(5)	0.5x2.8	0.3	3.8	3.8	1.7	19	10	Rad
FDD 1.25-110(8)	0.8x2.8	0.3	3.8	3.8	1.7	19	10	
FDD 1.25-187(5)	0.5x4.75	0.35	5.6	3.8	1.7	19	10	
FDD 1.25-187(8)	0.8x4.75	0.35	5.6	3.8	1.7	19	10	
FDD 1.25-205	0.5x5.2	0.35	6.5	3.8	1.7	20	10	
FDD 1.25-250	0.8x6.35	0.4	7.4	3.8	1.7	21	10	

Conductor section:1.5-2.5mm²(A.W.G16-14) I_{max}=15A Material:Brass

Item no.	Name tab (mm)	Thickness of material	Dimension(mm)					Color
			B	DΦ	dΦ	L	H	
FDD 2-110(5)	0.5x2.8	0.3	3.8	4.3	2.3	19	10	Blue
FDD 2-110(8)	0.8x2.8	0.3	3.8	4.3	2.3	19	10	
FDD 2-187(5)	0.5x4.75	0.35	5.6	4.3	2.3	19	10	
FDD 2-187(8)	0.8x4.75	0.35	5.6	4.3	2.3	19	10	
FDD 2-205	0.5x5.2	0.35	6.5	4.3	2.3	20	10	
FDD 2-250	0.8x6.35	0.4	7.4	4.3	2.3	21	10	
FDD 2-312	0.8x8.0	0.4	9	4.3	2.3	23	10	

Conductor section:1.5-2.5mm²(A.W.G12-10) I_{max}=24A Material:Brass

Item no.	Name tab (mm)	Thickness of material	Dimension(mm)					Color
			B	DΦ	dΦ	L	H	
FDD 5.5-250	0.8x6.35	0.4	7.4	5.7	3.4	25	13	Yellow
FDD 5.5-375	1.2x9.4	0.5	10.9	5.7	3.4	29.6	13	

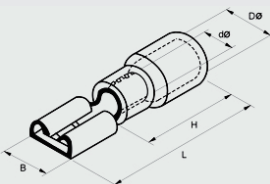



Male pre-insulating joint

Conductor section:0.5-1.5mm²(A.W.G22~16) I_{max}=10A Material:Brass

Item no.	Name tab (mm)	Thickness of material	Dimension(mm)					Color
			B	dΦ	DΦ	L	H	
MDD 1.25-110(5)	0.5x2.8	0.5	2.8	1.7	4.3	17.7	10	Rad
MDD 1.25-110(8)	0.8x2.8	0.8	2.8	1.7	4.3	17.7	10	
MDD 1.25-187(5)	0.5x4.75	0.5	4.75	1.7	4.3	20	10	
MDD 1.25-187(8)	0.8x4.75	0.8	4.75	1.7	4.3	20	10	
MDD 1.25-250	0.8x6.35	0.4 2	6.35	1.7	4.3	21	10	

Conductor section:1.5-2.5mm²(A.W.G16~14) I_{max}=15A Material:Brass

Item no.	Name tab (mm)	Thickness of material	Dimension(mm)					Color
			B	dΦ	DΦ	L	H	
MDD 2-187(5)	0.5x4.75	0.5	4.75	2.3	4.3	20	10	Blue
MDD 2-187(8)	0.8x4.75	0.8	4.75	2.3	4.3	20	10	
MDD 2-250	0.8x6.35	0.4 2	6.35	2.3	4.3	21	10	

Conductor section:1.5-2.5mm²(A.W.G12~10) I_{max}=24A Material:Brass

Item no.	Name tab (mm)	Thickness of material	Dimension(mm)					Color
			B	d	D	L	H	
MDD 5.5-250	0.8 6.35	0.4 2	6.35	3.4	5.7	25	13	Yellow

Shoule shaped male & Female pre-insulating joint

Conductor section:0.5-1.5mm²(A.W.G22~16) I_{max}=10A Material:Brass

Item no.	Name tab (mm)	Dimension(mm)					
		B	B1	H	DΦ	dΦ	L
PBDD 1.25-250	0.8x6.35	7.4	6.35	10.0	3.8	1.7	21.5

Conductor section:1.5-2.5mm²(A.W.G16~14) I_{max}=15A Material:Brass

Item no.	Name tab (mm)	Dimension(mm)					
		B	B1	H	DΦ	dΦ	L
PBDD 2-250	0.8 6.35	7.4	6.35	10	4.3	2.3	21.5

Conductor section:1.5-2.5mm²(A.W.G16~14) I_{max}=15A Material:Brass

Item no.	Name Tab (mm)	Dimension(mm)					
		B	B1	H	D	d	L
PBDD 5.5-250	0.8 6.35	7.4	6.35	13	5.7	3.4	25

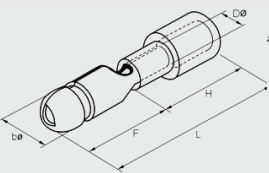
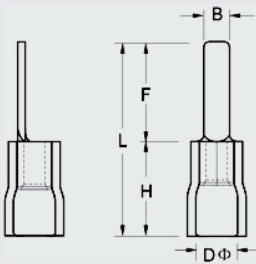

Chip-shaped pre-insulating terminal

Conductor section:0.5-1.5mm²(A.W.G22~16) I_{max}=19A Material:Copper

Item no.	Dimension(mm)					Color
	B	L	F	H	DΦ	
DBV 1.25-10	2.3	20	10	10	4.3	Rad
DBV 1.25-11	3	21	11			
DBV 1.25-14	3	24	14			
DBV 1.25-18	2.2	28	18			

Conductor section:1.5-2.5mm²(A.W.G16~14) I_{max}=27A Material:Copper

Item no.	Dimension(mm)					Color
	B	L	F	H	DΦ	
DBV 2-10	2.4	19	9	10	4.9	Blue
DBV 2-14	2.4	24	14			
DBV 2-18	2.2	28	18			

Conductor section:1.5-2.5mm²(A.W.G16~14) I_{max}=27A Material:Copper

Item no.	Dimension(mm)					Color
	B	L	F	H	DΦ	
DBV 5.5-10	2.8	22.5	10	13	5.6	Yellow
DBV 5.5-14	4.5	26.5	14			
DBV 5.5-18	4.5	30.5	18			

Bullet shaped male pre-insulating joint

Conductor section:0.5-1.5mm²(A.W.G22~16) I_{max}=19A Material:Brass

Item no.	Thickness of material	Dimension(mm)					Color
		dΦ	F	DΦ	H	L	
MPD 1.25-156	0.4	4	11	1.7	10	21	Rad

Conductor section:1.5-2.5mm²(A.W.G16~14) I_{max}=15A Material:Brass

Item no.	Thickness of material	Dimension(mm)					Color
		dΦ	F	DΦ	H	L	
MPD 2-156	0.4	4	11	2.3	10	21	Blue
MPD 2-195	0.4	5	11	2.3	10	21	

Conductor section:4-6mm²(A.W.G12~10) I_{max}=24A Material:Brass

Item no.	Thickness of material	Dimension(mm)					Color
		d	F	DΦ	H	L	
MPD 5.5-195	0.4	5	12	3.4	13	25	Yellow

Pre-insulating terminal

1

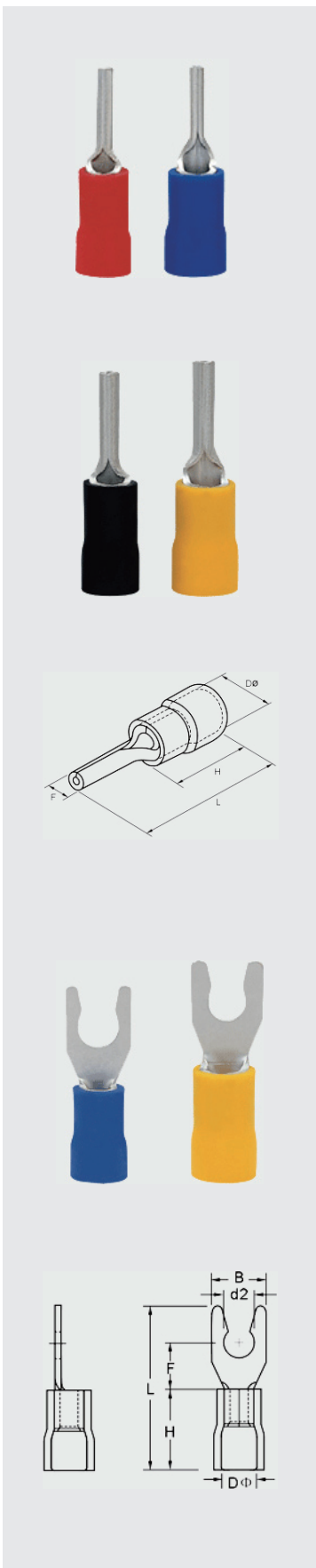

Pin-shaped pre-insulating terminal(Type TZ-JTK)

Conductor section:0.5-1.5mm²(A.W.G22~16) I_{max}=19A Material:Copper Thickness:0.75mm

Item no.	Dimension(mm)				Color
	F	L	H	DΦ	
PTV 1.25-9	1.9	19	10	4.3	Rad
PTV 1.25-10	1.9	20			
PTV 1.25-12	1.9	22			
PTV 1.25-13	1.9	23			
PTV 1.25-18	1.9	28			

Conductor section:1.5-2.5mm²(A.W.G16~14) I_{max}=27A Material:Copper Thickness:0.8mm

Item no.	Dimension(mm)				Color
	F	L	H	DΦ	
PTV 2-9	1.9	19	10	4.9	Blue
PTV 2-10	1.9	20			
PTV 2-12	1.9	22			
PTV 2-13	1.9	23			
PTV 2-18	1.9	28			

Conductor section:2.5-4mm²(A.W.G14~12) I_{max}=36A Material:Copper Thickness:1.0mm

Item no.	Dimension(mm)				Color
	F	L	H	DΦ	
PTV 3.5-10	2.8	20	13	6.2	Black
PTV 3.5-13	2.8	25.5			

Conductor section:4-6mm²(A.W.G12~10) I_{max}=48A Material:Copper Thickness:1.0mm

Item no.	Dimension(mm)				Color
	F	L	H	DΦ	
PTV 5.5-13	2.8	25.5	13	6.7	Yellow

Snapclose furcated pre-insulating terminal

Conductor section:0.5-1.5mm²(A.W.G22~16) I_{max}=19A Material:Copper Thickness:0.75mm

Item no.	American bolt number	d2Φ (mm)	Dimension(mm)				Color	
			B	L	F	H		
LSV 1.25-3.5	#6	3.7	6.4	21.2	6.5	10	4.3	Rad
LSVS 1.25-4	#8	4.3	7.2	21.2	6.5			
LSVL 1.25-4	#8	4.3	8.1	21.2	6.5			
LSVS 1.25-5	#10	5.3	8.1	21.2	6.5			
LSVL 1.25-5	#10	5.3	9.5	21.2	6.5			

Conductor section:1.5-2.5mm²(A.W.G16~14) I_{max}=27A Material:Copper Thickness:0.8mm

Item no.	American bolt number	d2Φ (mm)	Dimension(mm)				Color	
			B	L	F	H		
LSV 2-3.5	#6	3.7	6	21.2	6.5	10	4.9	Blue
LSVS 2-4	#8	4.3	7.2	21.2	6.5			
LSVL 2-4	#8	4.3	8.1	21.2	6.5			
LSVS 2-5	#10	5.3	8.1	21.2	6.5			
LSVL 2-5	#10	5.3	9.5	21.2	6.5			

Conductor section:4-6mm²(A.W.G12~10) I_{max}=48A Material:Copper Thickness:1.0mm

Item no.	American bolt number	d2Φ (mm)	Dimension(mm)				Color	
			B	L	F	H		
LSV 5.5-3.5	#6	3.7	8.3	25.2	7.5	13	6.7	Yellow
LSV 5.5-4	#8	4.3	8.3	25.2	7.5			
LSV 5.5-5	#10	5.3	9	23.9	7.5			
LSV 5.5-6	1/4	6.4	12	31.2	12			

1

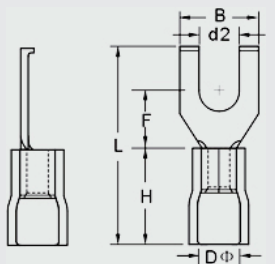
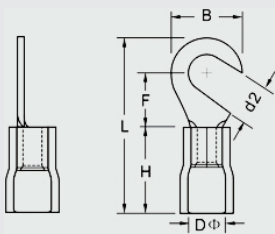

Hooked pre-insulating joint

Conductor section:0.5-1.5mm²(A.W.G22-16) I_{max}=19A Material:Copper Thickness:0.75mm

Item no.	American bolt number	d2 Φ (mm)	Dimension(mm)					Color
			B	L	F	H	D Φ	
HV 1.25-3.5	#6	3.7	8	21	7	10	4.3	Rad
HV 1.25-4	#8	4.3	8	21	7			
HV 1.25-5	#10	5.3	8	21	7			
HV 1.25-6	1/4	6.4	11.6	27	11.1			

Conductor section:1.5-2.5mm²(A.W.G16-14) I_{max}=27A Material:Copper Thickness:0.8mm

Item no.	American bolt number	d2 Φ (mm)	Dimension(mm)					Color
			B	L	F	H	D Φ	
HV 2-3.5	#6	3.7	8.5	22	7.75	10	4.9	Blue
HV 2-4	#8	4.3	8.5	22	7.75			
HV 2-5	#10	5.3	9.5	22	7.25			
HV 2-6	1/4	6.4	12	27	11			

Conductor section:4-6mm²(A.W.G12-10) I_{max}=48A Material:Copper Thickness:1.0mm

Item no.	American bolt number	d2 Φ (mm)	Dimension(mm)					Color
			B	L	F	H	D Φ	
HV 5.5-3.5	#6	3.7	7.2	21.4	5.9	13	6.7	Yellow
HV 5.5-4	#8	4.3	9.5	25.5	8.25			
HV 5.5-5	#10	5.3	9.5	25.5	8.25			
HV 5.5-6	1/4	6.4	12	31.5	13			

Male rucated pre-insulating joint

Conductor section:0.5-1.5mm²(A.W.G22-16) I_{max}=19A Material:Copper Thickness:0.75mm

Item no.	American bolt number	d2 Φ (mm)	Dimension(mm)					Color
			B	L	F	H	D Φ	
FSV 1.25-3.5	#6	3.7	7.5	19	5.1	10	4.3	Rad
FSV 1.25-4	#8	4.3	7.5	19	5.1			
FSV 1.25-5	#10	5.3	7.5	19	5.1			

Conductor section:1.5-2.5mm²(A.W.G16-14) I_{max}=27A Material:Copper Thickness:0.8mm

Item no.	American bolt number	d2 Φ (mm)	Dimension(mm)					Color
			B	L	F	H	D Φ	
FSV 2-3.5	#6	3.7	7.5	19	5.2	10	4.9	Blue
FSV 2-4	#8	4.3	7.5	19	5.2			
FSV 2-5	#10	5.3	7.5	19	5.2			

Conductor section:4-6mm²(A.W.G12-10) I_{max}=48A Material:Copper Thickness:1.0mm

Item no.	American bolt number	d2 Φ (mm)	Dimension(mm)					Color
			B	L	F	H	D Φ	
FSV 5.5-3.5	#6	3.7	8.5	25.5	7.5	13	6.7	Yellow
FSV 5.5-4	#8	4.3	8.5	25.5	7.5			
FSV 5.5-5	#10	5.3	8.5	25.5	7.5			

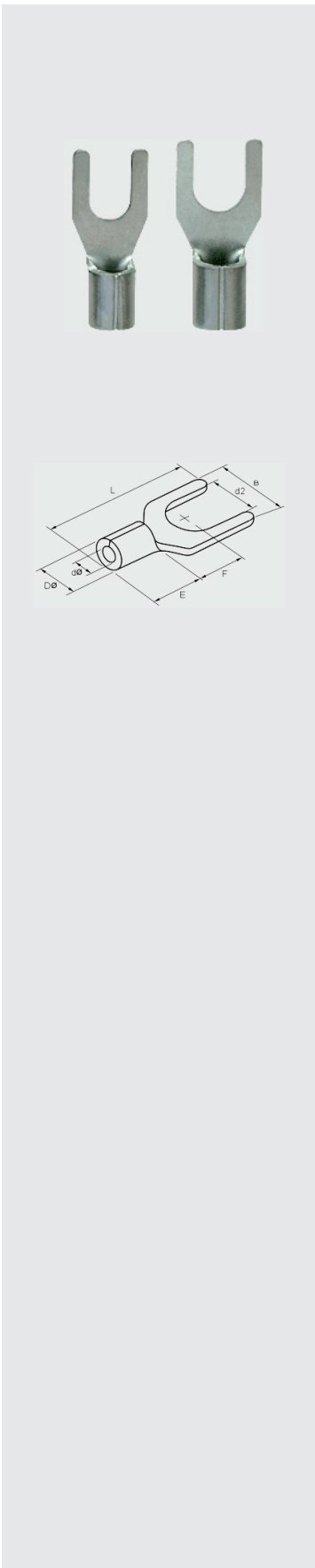

Furcate nated terminal(TYPE TU)

Conductor section:0.5-1.5mm²(A.W.G22~16) I_{max}=19A Material:Copper Thickness:0.7mm

Item no.	American bolt number	d2 Φ (mm)	Dimension(mm)					
			B	L	F	E	D Φ	d Φ
SNB 1.25-3	#4	3.2	5.7	16	6.5	4.8	3.4	1.7
SNBS 1.25-3.5	#6	3.7	5.7	16	6.5			
SNBL 1.25-3.5	#6	3.7	6.4	16	6.5			
SNBS 1.25-4	#8	4.3	6.4	16	6.5			
SNBM 1.25-4	#8	4.3	7.2	16	6.5			
SNBL 1.25-4	#8	4.3	8.1	16	6.5			
SNBS 1.25-5	#10	5.3	8.1	16	6.5			
SNBL 1.25-5	#10	5.3	9.5	16	6.5			
SNBS 1.25-6	1/4	6.4	9.5	16	6.5			
SNBL 1.25-6	1/4	8.4	12	22	11			

Conductor section:1.5-2.5mm²(A.W.G16~14) I_{max}=27A Material:Copper Thickness:0.8mm

Item no.	American bolt number	d2 Φ (mm)	Dimension(mm)					
			B	L	F	E	D Φ	d Φ
SNB 2-3	#4	3.2	5.7	16	6.5	4.8	4.1	2.3
SNBS 2-3.5	#6	3.7	5.7	16	6.5			
SNBL 2-3.5	#6	3.7	6	16	6.5			
SNBS 2-4	#8	4.3	6.4	16	6.5			
SNBM 2-4	#8	4.3	7.2	16	6.5			
SNBL 2-4	#8	4.3	8.1	16	6.5			
SNBS 2-5	#10	5.3	8.1	16	6.5			
SNBL 2-5	#10	5.3	9.5	16	6.5			
SNBS 2-6	1/4	6.4	9.5	16	6.5			
SNBL 2-6	1/4	6.4	12	22	11			

Conductor section:2.5-4mm²(A.W.G14~12) I_{max}=37A Material:Copper Thickness:1.0mm

Item no.	American bolt number	d2 Φ (mm)	Dimension(mm)					
			B	L	F	E	D Φ	d Φ
SNB 3.5-3	#8	3.2	5.7	18.3	7	6.0	5.0	3.0
SNB 3.5-4	#10	4.3	8	18.3	7			
SNB 3.5-5	#10	5.3	8	18.3	7			
SNB 3.5-6	1/4	6.4	12	21.5	12.1			

Conductor section:4-6mm²(A.W.G12~10) I_{max}=48A Material:Copper Thickness:1.0mm

Item no.	American bolt number	d2 Φ (mm)	Dimension(mm)					
			B	L	F	E	D Φ	d Φ
SNB 5.5-3.5	#6	3.7	8.3	19.5	7.5	6.8	5.6	3.4
SNBS 5.5-4	#8	4.3	8.3	19.5	7.5			
SNBL 5.5-4	#8	4.3	9	19.5	7.5			
SNB 5.5-5	#10	5.3	9	19.5	7.5			
SNBS 5.5-6	1/4	6.4	9	19.5	7.5			
SNBL 5.5-6	1/4	6.4	12	25.5	12			
SNB 5.5-8	5/16	8.4	14	24.5	11.5			

Material:Copper Thickness:1.2mm、1.4mm、1.7mm

Item no.	American bolt number	d2 Φ (mm)	Dimension(mm)					
			B	L	F	E	D Φ	d Φ
SNB 8-4	#8	4.3	8.7	23	6	8.5	7.2	4.5
SNB 8-5	#10	5.3	12.0	24.5	5.7	8.5	7.2	4.5
SNB 8-6	1/4	6.4	12.0	24.5	5.7	8.5	7.2	4.5
SNB 8-8	5/16	8.4	14.5	28.0	8.3	8.5	7.2	4.5
SNB 14-6	1/4	6.4	12.0	28.0	7.5	10.5	9.0	5.8
SNB 14-8	5/16	8.4	14.0	28.0	7.5	10.5	9.0	5.8
SNB 22-8	5/16	8.4	14.0	34.5	9.0	12.0	11.5	7.7

1

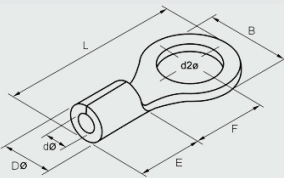

Circular rated terminal(TYPE TO)

Conductor section:0.5-1.5mm²(A.W.G22-16) I_{max}=19A Material:Copper Thickness:0.7mm

Item no.	American bolt number	d2 Φ (mm)	Dimension(mm)					D Φ	d Φ
			B	L	F	E			
RNB 1.25-3	#4	3.2	5.7	12.6	4.95	4.8	3.4	1.7	
RNBS 1.25-3.5	#6	3.7	5.7	12.6	4.95				
RNBM 1.25-3.5	#6	3.7	6.6	14.4	6.3				
RNBL 1.25-3.5	#6	3.7	8.0	15.8	7.0				
RNBS 1.25-4	#8	4.3	6.6	14.4	6.3				
RNBM 1.25-4	#8	4.3	8.0	15.8	7.0				
RNB 1.25-5	#10	5.3	8.0	15.8	7.0				
RNBL 1.25-5	#10	5.3	9.8	18.0	8.5				
RNBS 1.25-6	1/4	6.4	9.8	18.0	8.5				
RNB 1.25-6	1/4	6.4	11.6	21.8	11.1				
RNB 1.25-8	5/16	8.4	11.6	21.8	11.1				
RNB 1.25-10	3/8	10.5	13.6	25.5	13.9				
RNB 1.25-12	1/2	13.0	19.2	31.0	16.5				

Conductor section:1.5-2.5mm²(A.W.G16-14) I_{max}=27A Material:Copper Thickness:0.8mm

Item no.	American bolt number	d2 Φ (mm)	Dimension(mm)					D Φ	d Φ
			B	L	F	E			
RNB 2-3	#4	3.2	6.6	12.3	4.3	4.8	4.1	2.3	
RNBS 2-3.5	#6	3.7	6.6	12.3	4.3				
RNBM 2-3.5	#6	3.7	6.6	16.0	7.0				
RNBL 2-3.5	#6	3.7	8.5	16.8	7.75				
RNBS 2-4	#8	4.3	6.6	16.0	7.0				
RNBL 2-4	#8	4.3	8.5	16.8	7.75				
RNBS 2-5	#10	5.3	8.5	16.8	7.75				
RNBL 2-5	#10	5.3	9.5	16.8	7.25				
RNB 2-6	1/4	6.4	12.0	21.8	11.0				
RNB 2-8	5/16	8.4	12.0	21.8	11.0				
RNB 2-10	3/8	10.5	13.6	25.5	13.9				
RNB 2-12	1/2	13.0	19.2	31.0	16.5				

Conductor section:2.5-4mm²(A.W.G14-12) I_{max}=37A Material:Copper Thickness:1.0mm

Item no.	American bolt number	d2 Φ (mm)	Dimension(mm)					D Φ	d Φ
			B	L	F	E			
RNB 3.5-4	#8	4.3	8.0	18.0	7.7	6.0	5.0	3.0	
RNBS 3.5-5	#10	5.3	8.0	18.0	7.7				
RNBL 3.5-5	#10	5.3	12.0	21.4	7.7				
RNB 3.5-6	1/4	6.4	12.0	21.4	7.7				
RNB 3.5-8	6-15	8.4	15.0	28.0	13.7				

Conductor section:4-6mm²(A.W.G12-10) I_{max}=48A Material:Copper Thickness:1.0mm

Item no.	American bolt number	d2 Φ (mm)	Dimension(mm)					D Φ	d Φ
			B	L	F	E			
RNB 5.5-3.5	#6	3.7	7.2	15.7	5.9	6.8	5.6	3.4	
RNBS 5.5-4	#8	4.3	7.2	15.7	5.9				
RNBL 5.5-4	#8	4.3	9.5	19.8	8.3				
RNB 5.5-5	#10	5.3	9.5	19.8	8.3				
RNB 5.5-6	1/4	6.4	12.0	25.8	13.0				
RNB 5.5-8	5/16	8.4	15.0	28.0	13.7				
RNB 5.5-10	3/8	10.5	15.0	28.0	13.7				
RNB 5.5-12	1/2	13.0	19.2	32.4	16.0				

Circular nated terminal(TYPE TO)

Conductor section:6-10mm²(A.W.G 8) I_{max}=62A Material:Copper Thickness:1.2mm

Item no.	American bolt number	d2 Φ (mm)	Dimension(mm)					D Φ	d Φ
			B	L	F	E			
RNB 8-4	#8	4.3	8.8	23.8	9.3	8.5	7.2	4.5	
RNBS 8-5	#10	5.3	8.8	23.8	11.1				
RNBM 8-5	#10	5.3	12.0	23.8	9.3				
RNBL 8-5	#10	5.3	15.0	29.8	13.8				
RNBS 8-6	1/4	6.4	12.0	23.8	9.3				
RNBL 8-6	1/4	6.4	15.0	29.8	13.8				
RNB 8-8	5/16	8.4	15.0	29.8	13.8				
RNB 8-10	3/8	10.5	15.0	29.8	13.8				
RNB 8-12	1/2	13.0	20.0	33.5	15.0				

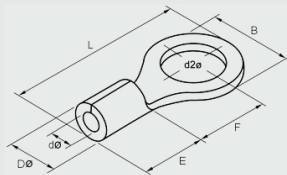

Conductor section:10-16mm²(A.W.G 6) I_{max}=88A Material:Copper Thickness:1.4mm

Item no.	American bolt number	d2 Φ (mm)	Dimension(mm)					D Φ	d Φ
			B	L	F	E			
RNB 14-4	#8	4.3	12	29.8	13.3	10.5	9	5.8	
RNB 14-5	#10	5.3	12	29.8	13.3				
RNBS 14-6	1/4	6.4	12	29.8	13.3				
RNBL 14-6	1/4	6.4	16	32.8	13.3				
RNB 14-8	5/16	8.4	16	32.8	14.5				
RNB 14-10	3/8	10.5	16	32.8	14.5				
RNB 14-12	1/2	13	22	41	19.5				

Conductor section:16-25mm²(A.W.G 4) I_{max}=115A Material:Copper Thickness:1.8mm

Item no.	American bolt number	d2 Φ (mm)	Dimension(mm)					D Φ	d Φ
			B	L	F	E			
RNBS 22-5	#10	5.3	12.2	33.2	14.5	12	11.5	7.7	
RNBL 22-5	#10	5.3	16.5	33.7	13.5				
RNBS 22-6	1/4	6.4	12.2	33.2	14.5				
RNBL 22-6	1/4	6.4	16.5	33.7	13.5				
RNB 22-8	5/16	8.4	16.5	33.7	13.5				
RNB 22-10	3/8	10.5	16.5	33.7	13.5				
RNB 22-11	7/16	11.5	22	42.5	19.5				
RNB 22-12	1/2	13	22	42.5	19.5				

Conductor section:35-50mm²(A.W.G 2) I_{max}=160A Material:Copper Thickness:1.8mm

Item no.	American bolt number	d2 Φ (mm)	Dimension(mm)					D Φ	d Φ
			B	L	F	E			
RNB 38-5	#10	5.3	15.3	39.0	18.3	14.0	13.3	9.4	
RNB 38-6	1/4	6.4	15.3	39.0	18.3				
RNBS 38-8	5/16	8.4	15.3	39.0	18.3				
RNBL 38-8	5/16	8.4	22.0	42.7	17.7				
RNBS 38-10	3/8	10.5	15.3	39.0	18.3				
RNBL 38-10	3/8	10.5	22.0	42.7	17.7				
RNB 38-11	7/16	11.5	22.0	42.7	17.7				
RNB 38-12	1/2	13.0	22.0	42.7	17.7				

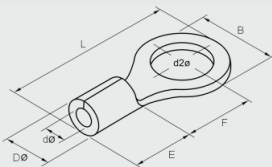

Circular rated terminal(TYPE TO)

Conductor section:50-70mm²(A.W.G 1/0) I_{max}=215A Material:Copper Thickness:1.8mm

Item no.	American bolt number	d2 Φ (mm)	Dimension(mm)					
			B	L	F	E	D Φ	d Φ
RNB 60-6	1/4	6.4	22.0	49.7	20.7	18.0	15.4	11.4
RNB 60-8	5/16	8.4						
RNB 60-10	3/8	10.5						
RNB 60-11	7/16	11.5						
RNB 60-12	1/2	13.0						
RNB 60-14	9/16	15.0						
RNB 60-16	5/8	17.0						
RNB 60-18	11/16	19.0						
RNB 60-20	3/4	21.0						
RNB 60-22	7/8	23.0						

Conductor section:70-95mm²(A.W.G 2/0) I_{max}=235A Material:Copper Thickness:2.0mm

Item no.	American bolt number	d2 Φ (mm)	Dimension(mm)					
			B	L	F	E	D Φ	d Φ
RNB 70-6	1/4	6.4	24.0	51.0	20.0	19.0	17.5	13.3
RNB 70-8	5/16	8.4						
RNB 70-10	3/8	10.5						
RNB 70-11	7/16	11.5						
RNB 70-12	1/2	13.0						
RNB 70-14	9/16	15.0						
RNB 70-16	5/8	17.0						
RNB 70-18	11/16	19.0						
RNB 70-20	3/4	21.0						
RNB 70-22	7/8	23.0						

Conductor section:95-120mm²(A.W.G 3/0) I_{max}=255A Material:Copper Thickness:2.2mm

Item no.	American bolt number	d2 Φ (mm)	Dimension(mm)					
			B	L	F	E	D Φ	d Φ
RNB 80-6	1/4	6.4	27.0	54.2	20.7	20.0	19.5	14.5
RNB 80-8	5/16	8.4						
RNB 80-10	3/8	10.5						
RNB 80-11	7/16	11.5						
RNB 80-12	1/2	13.0						
RNB 80-14	9/16	15.0						
RNB 80-16	5/8	17.0						
RNB 80-18	11/16	19.0						
RNB 80-20	3/4	21.0						
RNB 80-22	7/8	23.0						

Conductor section:120-150mm²(A.W.G 4/0) I_{max}=255A Material:Copper Thickness:2.5mm

Item no.	American bolt number	d2 Φ (mm)	Dimension(mm)					
			B	L	F	E	D Φ	d Φ
RNB 100-6	1/4	6.4	28.5	55.6	20.4	21.0	22.1	16.4
RNB 100-8	5/16	8.4						
RNB 100-10	3/8	10.5						
RNB 100-11	7/16	11.5						
RNB 100-12	1/2	13.0						
RNB 100-14	9/16	15.0						
RNB 100-16	5/8	17.0						
RNB 100-18	11/16	19.0						
RNB 100-20	3/4	21.0						
RNB 100-22	7/8	23.0						

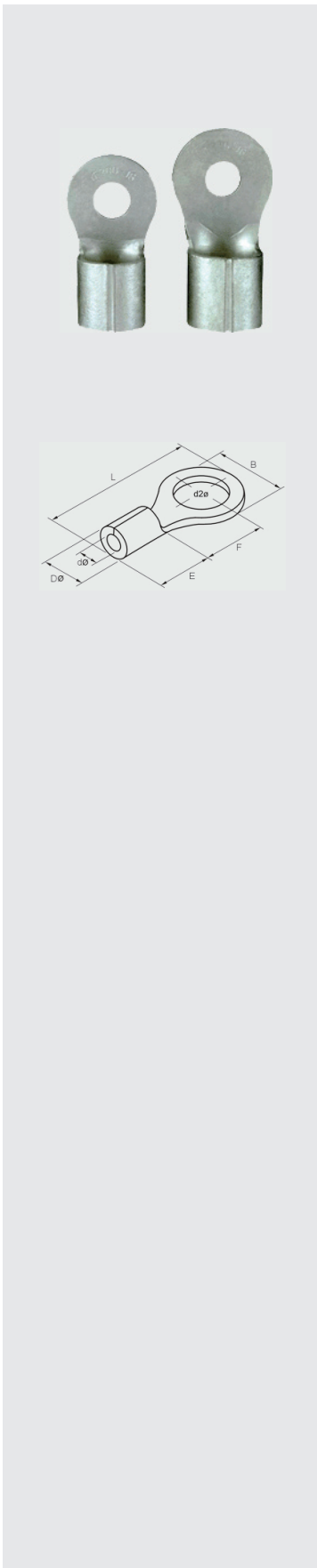

Circular rated terminal(TYPE TO)

Conductor section:150-185mm²(A.W.G 250/300MCB) I_{max}=395A Material:Copper Thickness:3.2mm

Item no.	American bolt number	d2 Φ (mm)	Dimension(mm)					D Φ	d Φ
			B	L	F	E			
RNB 150-8	5/16	8.4	36.0	66.0	23.0	27.0	26.6	19.5	
RNB 150-10	3/8	10.5							
RNB 150-11	7/16	11.5							
RNB 150-12	1/2	13.0							
RNB 150-14	9/16	15.0							
RNB 150-16	5/8	17.0							
RNB 150-18	11/16	19.0	36.0	81.0	36.0				
RNB 150-20	3/4	21.0							
RNB 150-22	7/8	23.0							
RNB 150-24	15/16	25.0							
RNB 150-27	1	28.0							

Conductor section:185-240mm²(A.W.G 300/350MCB) I_{max}=440A Material:Copper Thickness:3.5mm

Item no.	American bolt number	d2 Φ (mm)	Dimension(mm)					D Φ	d Φ
			B	L	F	E			
RNB 180-8	5/16	8.4	38.5	69.0	24.5	28.5	28.6	21	
RNB 180-10	3/8	10.5							
RNB 180-11	7/16	11.5							
RNB 180-12	1/2	13.0							
RNB 180-14	9/16	15.0							
RNB 180-16	5/8	17.0							
RNB 180-18	11/16	19.0	38.5	86.6	39.0				
RNB 180-20	3/4	21.0							
RNB 180-22	7/8	23.0							
RNB 180-24	15/16	25.0							
RNB 180-27	1	28.0							

Conductor section:240-300mm²(A.W.G 400/500MCB) I_{max}=470A Material:Copper Thickness:3.9mm

Item no.	American bolt number	d2 Φ (mm)	Dimension(mm)					D Φ	d Φ
			B	L	F	E			
RNB 200-8	5/16	8.4	44.0	72.0	24.5	31.5	32.6	24	
RNB 200-10	3/8	10.5							
RNB 200-11	7/16	11.5							
RNB 200-12	1/2	13.0							
RNB 200-14	9/16	15.0							
RNB 200-16	5/8	17.0							
RNB 200-18	11/16	19.0	44.0	91.0	37.5				
RNB 200-20	3/4	21.0							
RNB 200-22	7/8	23.0							
RNB 200-24	15/16	25.0							
RNB 200-27	1	28.0							

Conductor section:300-400mm²(A.W.G 500/600MCB) I_{max}=650A Material:Copper Thickness:4.2mm

Item no.	American bolt number	d2 Φ (mm)	Dimension(mm)					D Φ	d Φ
			B	L	F	E			
RNB 325-8	5/16	8.4	50.5	88.0	33.5	35.5	37.1	28.0	
RNB 325-10	3/8	10.5							
RNB 325-11	7/16	11.5							
RNB 325-12	1/2	13.0							
RNB 325-14	9/16	15.0							
RNB 325-16	5/8	17.0							
RNB 325-18	11/16	19.0	50.5	105.7	45.0				
RNB 325-20	3/4	21.0							
RNB 325-22	7/8	23.0							
RNB 325-24	15/16	25.0							
RNB 325-27	1	28.0							

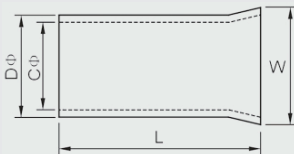

Tube naked terminal(TYPE TG)

U_{max}:1Ui=300V Material:Copper Pipe

Item no.	Dimension(mm)				Conductor section mm ²	
	L	D	C	W	A.W.G	mm ²
EN 0506	6.0	1.3	1.0	1.7	# 22	0.5
EN 0508	8.0					
EN 0510	10.0					
EN 0512	12.0					
EN 7506	6.0	1.5	1.2	1.9	# 20	0.75
EN 7508	8.0					
EN 7510	10.0					
EN 7512	12.0					
EN 1006	6.0	1.7	1.4	2.2	# 18	1.0
EN 1008	8.0					
EN 1010	10.0					
EN 1012	12.0					
EN 1507	7.0	2.0	1.7	2.5	# 16	1.5
EN 1508	8.0					
EN 1510	10.0					
EN 1512	12.0					
EN 1518	18.0					
EN 2507	7.0					
EN 2508	8.0					
EN 2510	10.0					
EN 2512	12.0					
EN 2518	18.0					
EN 4009	9.0	3.2	2.8	3.9	# 12	4.0
EN 4012	12.0					
EN 4018	18.0					
EN 6010	10.0	3.9	3.5	4.8	# 10	6.0
EN 6012	12.0					
EN 6015	15.0					
EN 6018	18.0					
EN 10-12	12.0					
EN 10-15	15.0					
EN 10-18	18.0					
EN 16-12	12.0	6.2	5.8	7.2	# 5	16.0
EN 16-15	15.0					
EN 16-18	18.0					
EN 25-16	16.0	7.9	7.5	9.1	# 4	25.0
EN 25-22	22.0					
EN 35-16	16.0	8.7	8.3	10.2	# 2	35.0
EN 35-25	25.0					
EN 50-20	20.0	10.9	10.3	12.4	# 1	50.0
EN 50-25	25.0					

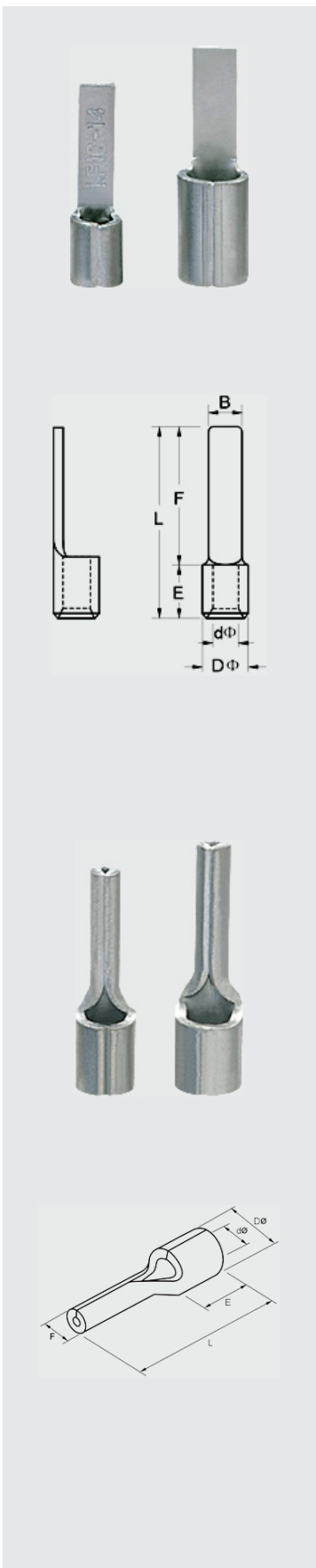

Chip-shaped naker terminal

Conductor section:0.5-1.5mm²(A.W.G 22-16) I_{max}=19A Material:Copper Thickness:0.75mm

Item no.	Dimension(mm)					
	B	L	F	H	DΦ	dΦ
DBN 1.25-10	2.3	14.8	10.0	4.8	3.4	1.7
DBN 1.25-11	3.0	15.8	11.0			
DBN 1.25-14	3.0	18.8	14.0			
DBN 1.25-18	2.2	22.8	18.0			

Conductor section:1.5-2.5mm²(A.W.G 16-14) I_{max}=27A Material:Copper Thickness:0.8mm

Item no.	Dimension(mm)					
	B	L	F	H	DΦ	dΦ
DBN 2-9	2.4	13.8	9.0	4.8	4.1	2.3
DBN 2-14	2.4	18.8	14.0			
DBN 2-18	2.2	22.8	18.0			

Conductor section:4-6mm²(A.W.G 12-10) I_{max}=48A Material:Copper Thickness:1.0mm

Item no.	Dimension(mm)					
	B	L	F	H	DΦ	dΦ
DBN 5.5-10	2.8	14.8	10.0	6.0	5.6	3.4
DBN 5.5-14	4.5	21.0	14.0			
DBN 5.5-18	4.5	23.0	18.0			
DBN 8-14	5.0	22.5	14.0	8.5	7.2	4.5
DBN 14-16	6.0	30.6	16.0	14.0	9.0	6.5

Pin-shaped nater terminal(TYPE TZ)

Conductor section:0.5-1.5mm²(A.W.G 22-16) I_{max}=19A Material:Copper Thickness:0.75mm

Item no.	Dimension(mm)				
	F	L	E	DΦ	dΦ
PTN 1.25-9	1.9	13.8	4.8	3.4	1.7
PTN 1.25-10	1.9	14.8			
PTN 1.25-12	1.9	16.8			
PTN 1.25-13	1.9	17.8			
PTN 1.25-18	1.9	22.8			

Conductor section:1.5-2.5mm²(A.W.G 16-14) I_{max}=27A Material:Copper Thickness:0.8mm

Item no.	Dimension(mm)				
	F	L	E	DΦ	dΦ
PTN 2-9	1.9	13.8	4.8	4.1	2.3
PTN 2-10	1.9	14.8			
PTN 2-12	1.9	16.8			
PTN 2-13	1.9	17.8			
PTN 2-18	1.9	22.8			

Conductor section:2.5-4mm²(A.W.G 14-12) I_{max}=37A Material:Copper Thickness:1.0mm

Item no.	Dimension(mm)				
	F	L	E	DΦ	dΦ
PTN 3.5-10	2.8	14.8	6	5	3
PTN 3.5-13	2.8	19.8			

Conductor section:4-6mm²(A.W.G 12-10) I_{max}=48A Material:Copper Thickness:1.0mm

Item no.	Dimension(mm)				
	F	L	E	DΦ	dΦ
PTN 5.5-13	2.8	19.8	6	5.6	3.4

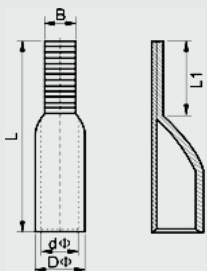
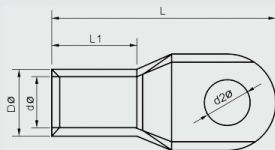

Copper connecting terminal(TYPE DTGA)

Item no.	d2Φ (mm)	Dimension(mm)				Conductor section(mm ²)
		dΦ	DΦ	L1	L	
SC 1.5-5	5.3	1.9	3.35	6.5	18.0	1.5
SC 2.5-4	4.3	2.6	4.0	7.0	18.0	2.5
SC 2.5-5	5.3	2.6	4.0	7.0	20.0	2.5
SC 4-5	5.3	3.2	4.8	7.5	20.5	4
SC 4-6	6.4	3.2	4.8	7.5	22.0	4
SC 6-5	5.3	3.7	5.3	8.0	24.0	6
SC 6-6	6.4	3.7	5.3	8.0	24.0	6
SC 10-6	6.4	4.5	6.3	9.0	24.0	10
SC 10-8	8.4	4.5	6.3	9.0	25.0	10
SC 16-6	6.4	5.7	7.5	11.0	27.5	16
SC 16-8	8.4	5.7	7.5	11.0	29.5	16
SC 25-6	6.5	7.2	9.0	13.5	34.0	25
SC 25-8	8.4	7.2	9.0	13.5	34.0	25
SC 35-8	8.4	8.5	10.8	14.5	37.0	35
SC 35-10	10.5	8.5	10.8	14.5	38.0	35
SC 50-8	8.4	9.8	12.5	17.0	42.5	50
SC 50-10	10.5	9.8	12.5	17.0	44.0	50
SC 70-10	10.5	11.5	14.5	19.5	50.0	70
SC 70-12	13.0	11.5	14.5	19.5	50.0	70
SC 95-10	10.5	13.7	17.0	23.5	57.0	95
SC 95-12	13.0	13.7	17.0	23.5	57.0	95
SC 120-12	13.0	15.0	19.0	26.0	63.0	120
SC 120-16	17.0	15.0	19.0	26.0	63.0	120
SC 150-12	13.0	16.7	21.0	29.0	71.0	150
SC 150-16	17.0	16.7	21.0	29.0	71.0	150
SC 185-16	17.0	18.5	23.0	33.0	79.0	185
SC 240-16	17.0	21.0	26.0	40.0	91.0	240
SC 240-20	21.0	21.0	26.0	40.0	92.0	240
SC 300-16	17.0	24.0	30.0	44.0	100.0	300
SC 300-20	21.0	24.0	30.0	44.0	102.0	300
SC 400-16	17.0	27.0	34.0	46.0	102.0	400
SC 400-20	21.0	27.0	34.0	46.0	113.0	400
SC 500-16	17.0	30.0	38.0	50.0	123.0	500
SC 500-20	21.0	30.0	38.0	50.0	123.0	500
SC 630-20	21.0	35.0	45.0	56.0	135.0	630
SC 800-BL	-	39.0	50.0	60.0	170.0	800
SC 1000-BL	-	44.0	56.0	87.0	200.0	1000

C45 insert needle naked terminal

Material:Copper pipe

Item no.	Dimension(mm)				
	DΦ	dΦ	L	L1	B
C-102	7.5	5	34	13.5	7
C-162	8.5	6	35	14	7
C-252	10	7	36	14.5	7
C-352	11	8	37	15	7
C-502	13	10	41	15.5	7
C-702	16	12	45	16	7
C-952	18	14	50	18	9
C-1202	20	15	57	20	9
C-1502	22	17	67	24	9
C-1852	24	19	77	28	9
C-2402	26	21	85	31	9

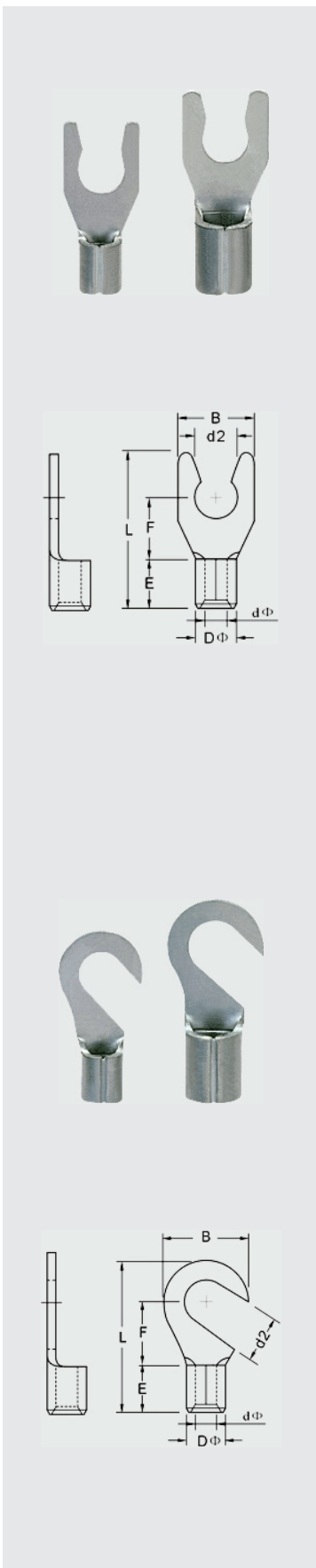

Snapclose furcate naked terminal

Imax=19A Material:Copper Thickness:0.75mm

Item no.	d2 Φ (mm)	Dimension(mm)						A.W.G mm ²
		B	F	L	E	D Φ	d Φ	
LSNB 1.25-3.5	3.7	6.4	6.4	16	4.8	3.4	1.7	22-16A.W.G 0.5-1.5mm ²
LSNBS 1.25-4	4.3	7.2						
LSNBL 1.25-4	4.3	8.1						
LSNBS 1.25-5	5.3	8.1						
LSNBL 1.25-5	5.3	9.5						

Imax=27A Material:Copper Thickness:0.8mm

Item no.	d2 Φ (mm)	Dimension(mm)						A.W.G mm ²
		B	F	L	E	D Φ	d Φ	
LSNB 2-3.5	3.7	6.0	6.4	16.0	4.8	4.1	2.3	16-14A.W.G 1.5-2.5mm ²
LSNBS 2-4	4.3	7.2						
LSNBL 2-4	4.3	8.1						
LSNBS 2-5	5.3	8.1						
LSNBL 2-5	5.3	9.5						

Imax=48A Material:Copper Thickness:1.0mm

Item no.	d2 Φ (mm)	Dimension(mm)						A.W.G mm ²
		B	F	L	E	D Φ	d Φ	
LSNB 5.5-3.5	3.7	8.3	7.5	19.5	6.0	5.6	3.4	12-10A.W.G 4-6mm ²
LSNB 5.5-4	4.3	8.3						
LSNB 5-5	5.3	9.0						
LSNB 5-6	6.4	12.0	12.0	24.5				

Hooked naked terminal

Imax=19A Material:Copper Thickness:0.75mm

Item no.	d2 Φ (mm)	Dimension(mm)						A.W.Gmm ²
		B	F	L	E	D Φ	d Φ	
HNB 1.25-3.5	3.7	8.0	7.0	15.8	4.8	3.4	1.7	22-16A.W.G 0.5-1.5mm ²
HNB 1.25-4	4.3							
HNB 1.25-5	5.3							
HNB 1.25-6	6.4	11.6	11.0	21.8				

Imax=27A Material:Copper Thickness:0.8mm

Item no.	d2 Φ (mm)	Dimension(mm)						A.W.Gmm ²
		B	F	L	E	D Φ	d Φ	
HNB 2-3.5	3.7	8.5	7.8	16.8	4.8	4.1	2.3	16-14A.W.G 1.5-2.5mm ²
HNB 2-4	4.3							
HNB 2-5	5.3	9.5	7.3					
HNB 2-6	6.4	12.0	11.0	21.8				

Imax=48A Material:Copper Thickness:1.0mm

Item no.	d2 Φ (mm)	Dimension(mm)						A.W.Gmm ²
		B	F	L	E	D Φ	d Φ	
HNB 5.5-3.5	3.7	7.2	6.1	15.7	6.0	5.6	3.4	12-10A.W.G 4-6mm ²
HNB 5.5-4	4.3	9.5	9.5	19.8				
HNB 5.5-5	5.3							
HNB 5.5-6	6.4	12.0	10.3	22.5				
HNB 5.5-8	8.4	12.0	11.0	21.8				

Imax=62A Material:Copper Thickness:1.2mm

Item no.	d2 Φ (mm)	Dimension(mm)						A.W.Gmm ²
		B	F	L	E	D Φ	d Φ	
HNB 8-8	8.4	15.0	13.8	29.5	8.5	7.2	4.5	8A.W.G 8mm ²

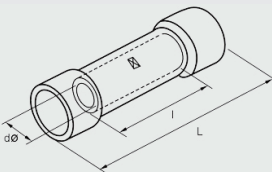
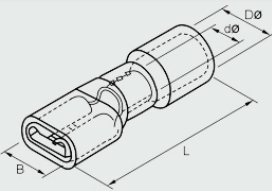

Female full-insulating joint

Wire range:0.5~1.5mm²(A.W.G22-16) MAX AMP:1max=10A Material:Brass

Item no.	Name tab(mm)	Dimension(mm)			
		B	D Φ	d Φ	L
DFDFD 1.25-187(5)	0.5x4.75	5.6	3.8	1.7	20
DFDFD 1.25-187(8)	0.8x4.75	5.6	3.8	1.7	20
DFDFD 1.25-250	0.8x6.35	7.4	3.8	1.7	21.5

Wire range:1.5~2.5mm²(A.W.G16-14) MAX AMP:1max=15A Material:Brass

DFDFD 2-187(5)	0.8x4.75	5.6	4.3	2.3	20
DFDFD 2-187(8)	0.8x4.75	5.6	4.3	2.3	20
DFDFD 2-250	0.8x6.35	7.4	4.3	2.3	21.5

Wire range:4~6mm²(A.W.G12-10) MAX AMP:1max=24A Material:Brass

DFDFD 5.5-250	0.8x6.35	7.4	5.7	3.4	25.5
---------------	----------	-----	-----	-----	------

Long full insulating middle joint(TYPE-JTK)

Material:Copper Insulating Material:PVC

Item no.	Conductor section		Dimension(mm)			Imax	Color
	A.W.G	mm ²	l	d Φ	L		
BV 1.25	22-16	0.5-1.5	15.0	1.7	26.0	19A	Rad
BV 2	16-14	1.5-2.5	15.0	2.3	26.0	27A	Blue
BV 5.5	12-10	4-6	15.0	3.4	26.0	48A	Yellow
BV 8	#8	6-10	21.0	4.5	32.0	62A	Rad
BV 14	#6	10-16	26.0	5.8	42.0	88A	Blue
BV 22	#4	16-25	29.0	7.7	50.0	115A	Yellow
BV 38	#2	35-50	32.0	9.4	55.0	160A	Rad

Short full insulating middle joint(TYPE-JTK)

Material:Copper Insulating Material:PVC

Item no.	Conductor section		Dimension(mm)			Imax	Color
	A.W.G	mm ²	l	d Φ	L		
PVT 1.25	22-16	0.5-1.5	8.0	1.7	16.0	19A	Rad
PVT 2	16-14	1.5-2.5	8.0	2.3	16.0	27A	Bule
PVT 5.5	12-10	4-6	8.0	3.4	20.5	48A	Yellow

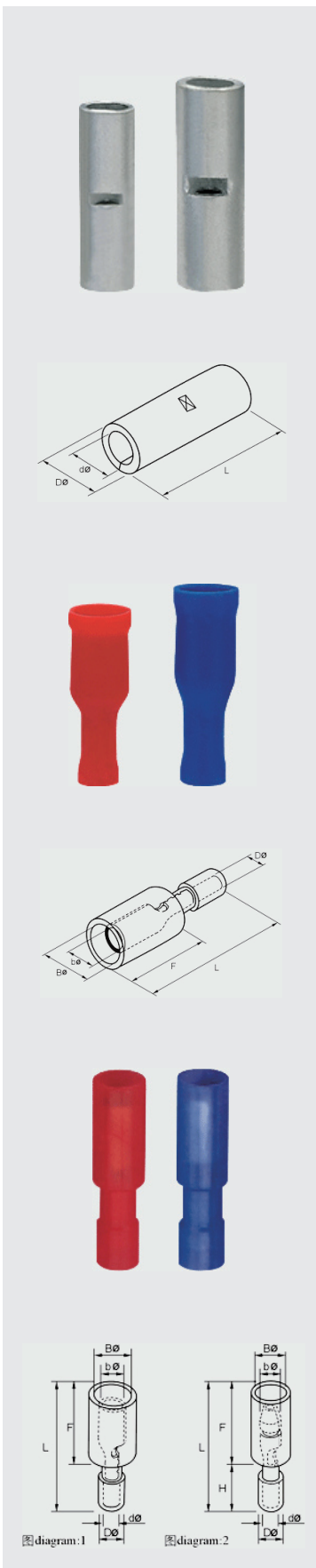

Naked terminal in the middle

Material:Copper

Item no.	Conductor section		Dimension(mm)		
	A.W.G	mm ²	D Φ	d Φ	L
BN 1.25	22-16	0.5-1.5	3.3	1.7	15.0
BN 2	16-14	1.5-2.5	4.0	2.3	15.0
BN 3.5	14-12	2.5-4	5.0	3.0	15.0
BN 5.5	12-10	4-6	5.5	3.4	15.0
BN 8	#8	10	7.1	4.5	21.0
BN 14	#6	16	9.0	5.8	26.0
BN 22	#4	25	11.4	7.7	29.0
BN 38	#2	35	13.3	9.4	32.0
BN 60	1/0	50	15.4	11.4	36.0
BN 70	2/0	70	17.5	13.3	37.0
BN 80	3/0	95	19.4	14.5	38.0
BN 100	4/0	120	22.0	16.4	38.0
BN 150	250-300MCM	150	26.5	19.5	54.0
BN 180	300-350MCM	185	28.5	21.0	57.0
BN 200	400MCM	240	32.5	24.0	63.0
BN 325	500-600MCM	300	37.0	28.0	72.0

Bullet shaped female insulating joint

Conductor section:0.5~1.5mm²(A.W.G 22~16) I_{max}=10A Material:Brass

Item no.	Thickness of material	Dimension(mm)					Color
		b Φ	B Φ	D Φ	H	L	
FRD 1.25-156	0.4	4	6.3	1.7	13	24.5	Rad

Conductor section:1.5~2.5mm²(A.W.G 16~14) I_{max}=15A Material:Brass

Item no.	Thickness of material	Dimension(mm)					Color
		b Φ	B Φ	D Φ	H	L	
FRD 2-156	0.4	4	6.3	2.3	14	24.5	Blue
FRD 2-195	0.4	5	7	2.3	14	25.5	

Conductor section:4~6mm²(A.W.G 12~10) I_{max}=24A Material:Brass

Item no.	Thickness of material	Dimension(mm)					Color
		b Φ	B Φ	D Φ	H	L	
FRD 5.5-195	0.4	5	7	3.4	14	29.5	Yellow

Bullet shaped female insulating joint

Conductor section:0.5~1.5mm²(A.W.G 22~16) I_{max}=10A Material:Brass

Item no.	Dimension(mm)							Fig	A.W.G mm ²	Color
	B	b	D	d	L	F	H			
FRFNY 1.25-156	6.9	3.9	3.2	1.8	26.0	15.0	11.0	1	22~16 A.W.G. 0.5~1.5mm ²	Red
MRFNY 1.25-156	7.4	4.0	3.2	1.8	27.5	16.5	11.0	2	22~16 A.W.G. 0.5~1.5mm ²	Red
FRFNY 2-156	6.9	3.9	3.9	2.4	26.0	15.5	11.0	1	16~14 A.W.G. 1.5~2.5mm ²	Blue
FRFNY 2-156	7.4	4.0	3.9	2.4	27.5	16.5	11.0	2	16~14 A.W.G. 1.5~2.5mm ²	Blue

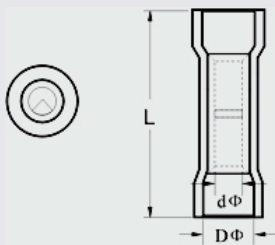

Long full insulating middle joint(NYLON)

Imax:26-22 A.W.G:9A 22-16 A.W.G:19A
16-14 A.W.G:27A 12-10 A.W.G:48A

Max withstanding pressure:105°C 600V Insulating Cover Material:Nylon

Item no.	Dimension(mm)			Joint material	A.W.G mm ²	Color
	L	D Φ	d Φ			
BNYF 0.5	20	2	1.3	Copper pipe	26~22 A.W.G. 0.2~0.5mm ²	Yellow
BNYF 1.25	27.3	3.2	1.7	Copper pipe	22~16 A.W.G. 0.5~1.5mm ²	Red
BNYF 2	27.3	3.8	2.3	Copper pipe	16~14 A.W.G. 1.5~2.5mm ²	Blue
BNYF 5.5	27.3	5.3	3.4	Copper pipe	12~10 A.W.G. 4~6mm ²	Yellow

Item no.	Dimension(mm)			Joint material	A.W.G mm ²	Color
	L	D Φ	d Φ			
BNY 1.25	27.3	3.2	1.7	Copper pipe	22~16 A.W.G. 0.5~1.5mm ²	Red
BNY 2	27.3	3.8	2.3	Copper pipe	16~14 A.W.G. 1.5~2.5mm ²	Blue
BNY 5.5	27.3	5.3	3.4	Copper pipe	12~10 A.W.G. 4~6mm ²	Yellow

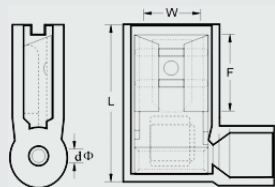
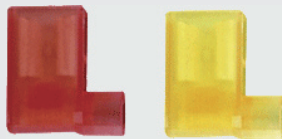

Flag female insulating joint(NYLON)

Imax:22-18 A.W.G:10A 16-14 A.W.G:15A 12-10 A.W.G:24A

Max withstanding pressure:105°C 600V
Material:Brass Insulating Cover Material:Nylon
Thickness:0.4mm

Item no.	Connect specification	Dimension(mm)				A.W.Gmm ²
		W	F	L	d Φ	
FLDNY 1.25-250	0.8X6.35	6.6	7.6	16	1.7	22~18 A.W.G. 0.5~1.5mm ²
FLDNY 2-250	0.8X6.35	6.6	7.6	16	1.7	16~14 A.W.G. 1.35~2.5mm ²
FLDNY 5.5-250	0.8X6.35	6.6	7.6	16	1.7	12~10 A.W.G. 4~6mm ²



Male and female full-insulating joint(NYLON)

Imax:10A Material:Brass Insulating Cover Material:NYLON

Item no.	Connect specification	Dimension(mm)							Fig	A.W.Gmm ²	Color
		W	F	L	B	DΦ	CΦ	T			
FDN 1.25-250	0.8X6.35	6.6	7.3	22.0	11.0	4.0	1.7	0.4	1	22~16 A.W.G.	Red
MDFN 1.25-250	0.8X6.35	6.35	7.7	23.0					2	0.5~1.5mm ²	

Imax:15A Material:Brass Insulating Cover Material:NYLON

Item no.	Connect specification	Dimension(mm)							Fig	A.W.Gmm ²	Color
		W	F	L	B	DΦ	CΦ	T			
FDN 2-250	0.8X6.35	6.6	7.3	22.0	11.0	4.5	2.3	0.4	1	16~14 A.W.G.	Blue
MDFN 2-250	0.8X6.35	6.35	7.7	24.0					2	1.5~2.5mm ²	

Imax:24A Material:Brass Insulating Cover Material:NYLON

Item no.	Connect specification	Dimension(mm)							Fig	A.W.Gmm ²	Color
		W	F	L	B	DΦ	CΦ	T			
FDN 5.5-250	0.8X6.35	6.6	7.3	24.0	13.0	6.3	3.4	0.4	1	12~10 A.W.G.	Yellow
MDFN 5.5-250	0.8X6.35	6.35	7.7	25.0					2	4~6mm ²	

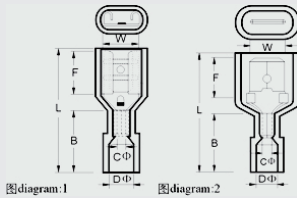

Male and female full-insulating joint(NYLON)

Imax:10A Material:Brass Insulating Cover Material:NYLON

Item no.	Connect specification	Dimension(mm)							Fig	A.W.Gmm ²	Color
		W	F	L	B	DΦ	CΦ	T			
FDNY 1.25-250	0.8X6.35	6.6	7.3	22	12.0	4.0	1.7	0.45	1	22~16 A.W.G.	Red
MDFNY 1.25-250	0.8X6.35	6.35	7.7	23	11.0	4.0	1.7	0.8	2	0.5~1.5mm ²	



Imax:15A Material:Brass Insulating Cover Material:NYLON

Item no.	Connect specification	Dimension(mm)							Fig	A.W.Gmm ²	Color
		W	F	L	B	DΦ	CΦ	T			
FDNY 2-250	0.8X6.35	6.6	7.3	23.0	12.0	4.5	2.3	0.45	1	16~14 A.W.G.	Blue
MDFNY 2-250	0.8X6.35	6.35	7.7	24.0	11.0	4.5	2.3	0.8	2	1.5~2.5mm ²	

Imax:24A Material:Brass Insulating Cover Material:NYLON

Item no.	Connect specification	Dimension(mm)							Fig	A.W.Gmm ²	Color
		W	F	L	B	DΦ	CΦ	T			
FDNY 5.5-250	0.8X6.35	6.6	7.3	23.0	12.0	5.0	3.4	0.45	1	12~10 A.W.G.	Yellow
MDFNY 5.5-250	0.8X6.35	6.35	7.7	24.0	11.0	5.0	3.4	0.8	2	4~6mm ²	

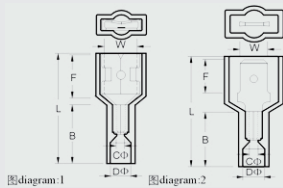

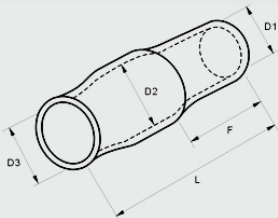

Insulated teleflex

Material:PVC

Item no.	Dimension(mm)				
	D1	D2	D3	L	F
V 1.25	2.8	3.3	3.1	13.0	7.0
V 2	3.3	4.5	3.7	15.0	7.0
V 3.5	4.2	5.7	4.1	20.0	8.0
V 5.5	4.8	5.7	5.2	20.0	8.0
V 8	6.2	7.2	6.2	20.0	9.0
V 14	7.5	10	8.0	27.0	11.0
V 22	10.5	12	9.5	30.0	15.0
V 38	12.5	14	11.8	36.0	16.5
V 60	15.0	16.8	13.5	39.0	19.0
V 70	16.0	17.5	14.5	43.0	20.0
V 80	17.0	19.0	16.0	47.0	22.0
V 100	19.0	22.0	18.0	54.0	24.0
V 125	21.0	24.0	20.0	57.0	25.0
V 150	23.0	24.5	22.0	65.0	30.0
V 200	27.0	32.0	24.0	65.0	30.0
V 240	29.0	38.0	26.5	77.0	39.0
V 325	29.0	38.0	29.0	77.0	40.0
V 400	42.0	45.0	36.0	85.0	41.0
V 500	46.0	48.0	40.0	88.0	42.0
V 630	52.0	54.0	44.0	92.0	47.0

Fast connecting joint

Imax:22-18 A.W.G:10 18-14 A.W.G:15A 12-10A.W.G:24A
 Umax:105°C 600V Material:brass Insulating Material:PP

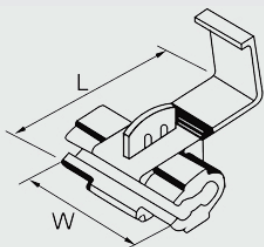
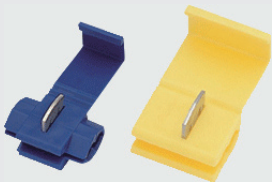

Item no.	Dimension(mm)		A.W.Gmm ²	Color
	F	L		
878100	20.0	27.0	22-18 A.W.G 0.5-1.0mm ²	Red
878101	20.0	27.0	18-14 A.W.G 0.75-2.5mm ²	Blue
878101	20.0	27.0	18-14 A.W.G 0.75-2.5mm ²	White
878201	20.5	34.5	12-10 A.W.G 4-6mm ²	Yellow

Close-end wire connector

Shell material: Nylon 66,94V-2,certificated agree by UL.

Usage: Peel the coat of wire,then insert to tube,use pincers to fix them.

Feature: Nylon shell, long copper tube, easy to conduct electricity and hold wire tightly.

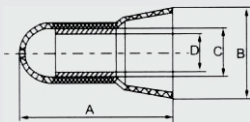

ITEM NO.	A(mm)	W(mm)		D(mm)	Suitable Wires		Packing
		B	C		mm ²	AWG	
DL-Φ3	17.8	7.2	3.6	2.5	1.25	22-16	100PCS & 1000PCS
DL-Φ4	21.0	8.2	4.0	2.9	2.0	16-14	100PCS & 1000PCS
DL-Φ5	22.5	9.0	4.8	3.9	5.5	12-10	100PCS & 1000PCS
DL-Φ6	25.0	10.0	5.6	4.5	8.0	8	100PCS & 1000PCS
DL-Φ7	24.2	11.0	6.5	5.4	10	8-6	100PCS & 500PCS
DL-Φ8	25.6	11.8	7.5	6.0	13	6	100PCS & 500PCS
DL-Φ10	29.5	13.5	9.3	7.5	16	4	100PCS

Screw press line cap

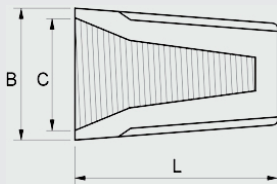

Item no.	Lead combination range	Dimension(mm)			Color
		B	C	L	
SP1	Min0.75 1+0.5 1 max1.5 2	8.5	6.7	15	Gray
SP2	Min0.75 3 max1.5 3	10.1	7.4	17.5	Blue
SP3	Min0.75 3 max1.5 3+1 1	12.6	9.9	22.1	Orange
SP4	Min0.25 1+0.75 1 max2.5 4+0.75 1	13.7	11	24.5	Yellow
SP5	Min0.25 2 max6 2+4 2	16	13	26.5	Red

1



Open barrel terminals

Type	Wire Range(mm ²)	Material	Thickness(mm)	Fig
12.5T	AWG32~28	QSn6.5-0.1	0.15	A
PH	AWG30~24	QSn6.5-0.1	0.2	B
SAN	AWG30~24	QSn6.5-0.1	0.2	C
Jc20	AWG30~24	QSn6.5-0.1	0.2	D

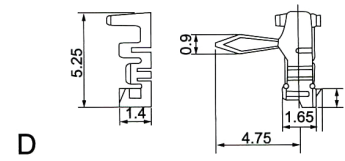
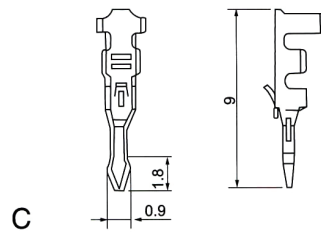
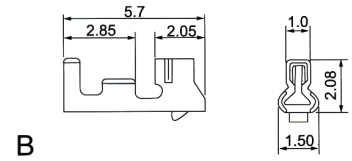
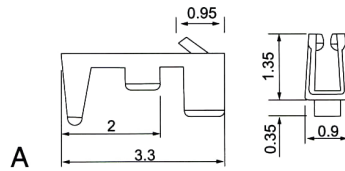

Type	Wire Range(mm ²)	Material	Thickness(mm)	Fig
TJC3(XH)	AWG28~22	QSn6.5-0.1	0.2	E
SM	AWG28~22	QSn6.5-0.1	0.2	F
SM	AWG28~22	QSn6.5-0.1	0.25	G
SCN	AWG28~22	QSn6.5-0.1	0.2	H

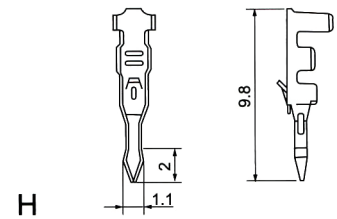
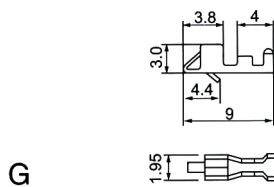
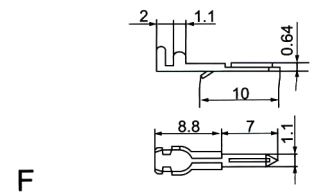
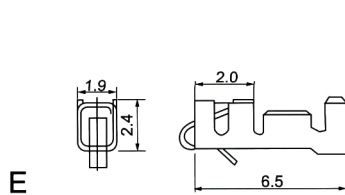

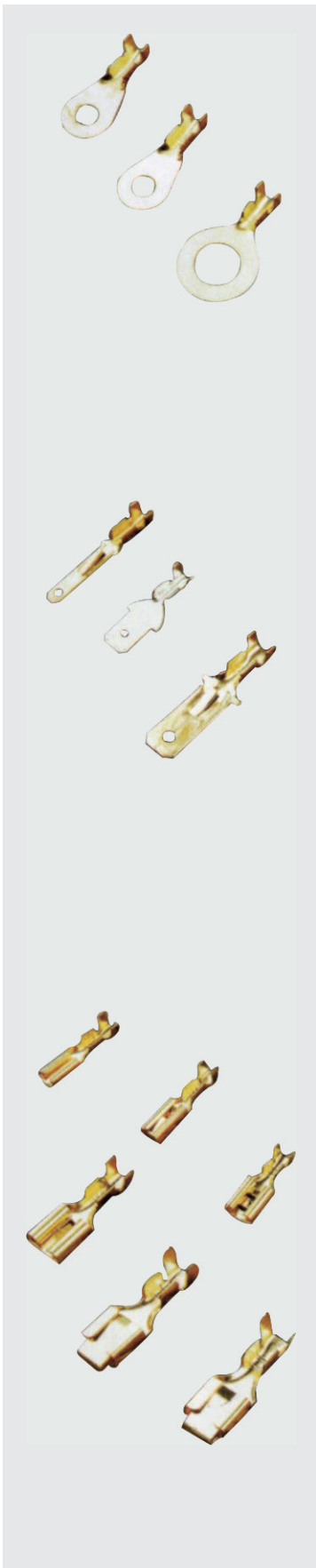

Open barrel terminals(FEMALE & MALE)

Item no.	Metal	Wire range	Dimension			Thickness
			D	W	E	
Y3-2.5	Brass	0.5-2.5	3.2	-	-	0.6
DJ431-3A	Brass	0.5-0.8	3.5	9.0	17.0	0.5
DJ431-5A	Brass	0.5-0.8	5.2	10.0	17.0	0.5
DJ431-6A	Brass	0.5-0.8	6.2	12.0	17.0	0.5
DJ431-8B	Brass	1.0-1.5	8.2	15.0	17.0	0.8
DJ431-10B	Brass	1.0-1.5	10.5	19.0	19.0	0.8

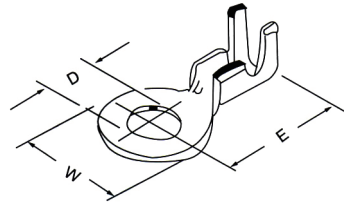

Item no.	Metal	Wire range	Dimension				Thickness	Fig
			D	W	L	E		
DJ611-2.8 0.5B	Brass	1.0-1.5	/	2.8	21.0	12.0	0.5	A
DJ611-6.3A	Brass	0.5-0.8	7.9	6.3	25.0	13.8	0.4	B
DJ611-6.3B	Brass	1.0-1.5	7.9	6.3	25.0	13.8	0.4	B
DJ612-6.3C	Brass	2.0-2.5	7.9	6.3	25.0	13.8	0.4	B
DJ617-6.3B	Brass	1.0-1.5	/	6.3	19.2	/	0.4	C

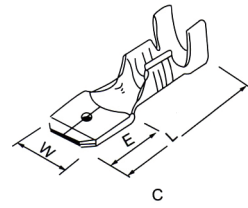
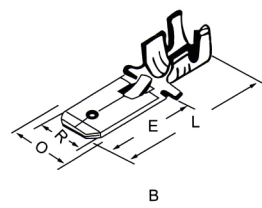
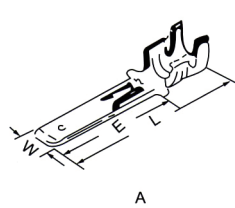

Item no.	Metal	Wire range	Dimension			Thickness	Fig
			W	L	E		
DJ621-E2.8 0.5B	Brass	1.0-1.5	4.1	16	6.6	0.3	A
DJ621-D2.8 0.5A	Brass	0.5-0.8	3.7	15.1	6.3	0.25	A
DJ621-E4.8 0.5A	Brass	0.5-0.8	6	13.8	-	0.3	A
DJ625-4.8 0.8A	Brass	0.5-0.8	6.4	12	6.2	0.4	B
DJ621-5A	Brass	0.5-0.8	5.2	17	5.5	0.3	C
DJ611-5B	Brass	1.0-1.5	5.2	17	5.5	0.3	C
DJ622-A6.3B	Brass	1.0-1.5	7.7	18.5	7.5	0.4	D
DJ622-D6.3B	Brass	1.0-1.5	7.7	17.5	7.5	0.4	E

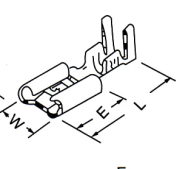
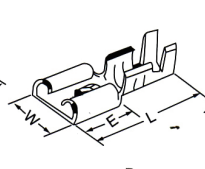
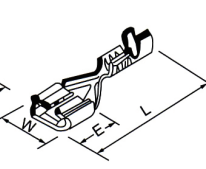
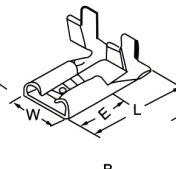
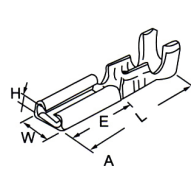

1

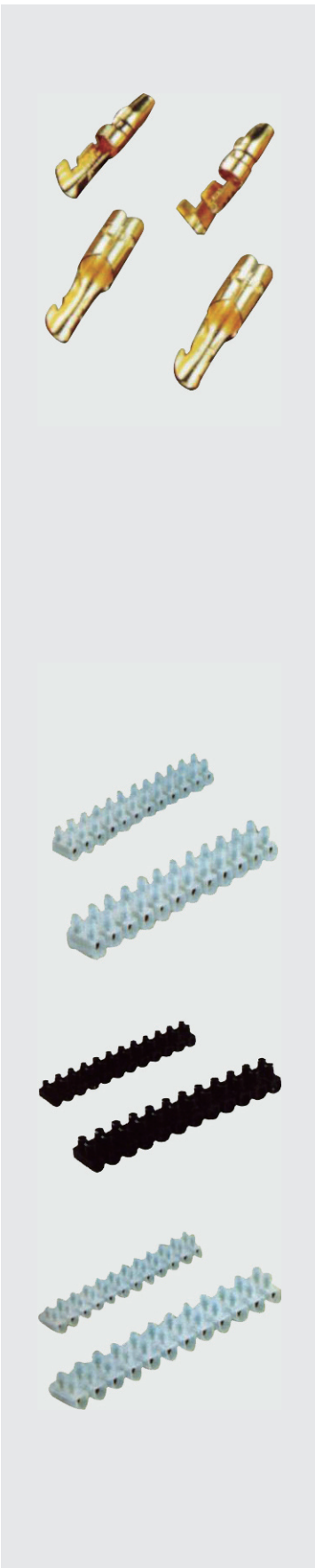

Open barrel terminals

Item no.	Metal	Wire range	Dimension					Thickness	Fig
			D	H	W	L	E		
DJ211-3.5B	Brass	1.0-1.5	-	-	3.5	15	-	0.5	A
DJ211-4B	Brass	1.0-1.5	-	-	4	16	-	0.5	A
DJ221-2.3B	Brass	1.0-1.5	-	-	3.9	19	7.4	0.3	B
DJ221-3.5B	Brass	1.0-1.5	-	-	3.3	17.6	6.5	0.3	B
DJ221-4B	Brass	1.0-1.5	-	-	3.8	17.6	6.5	0.4	B

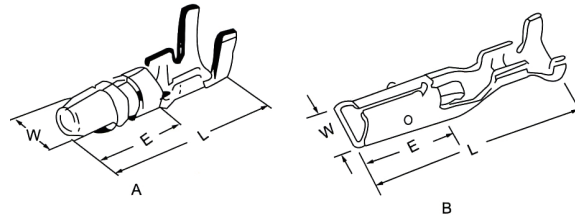

Terminal blocks

Terminal blocks H,U(W),V(F)TYPE
Material:made from PA,PE or PP.

Application

H.F.W.Series terminal connectors are used in the circuits of AC.50Hz or 60Hz voltage up to 660V or DC.Volitage up to 440V current from 3A to 150A ,for connecting the round copper conductors.

Specification

Item no.	L	A	H	M	B	mm ²	Volt	Amp	Packing
DL-3A	93	16	12	6	8	4	400V	3A	10PCS
DL-6A	115	15.7	13	6.5	9.5	6	400V	6A	10PCS
DL-10A	126	20.2	15.5	8.4	10.5	10	400V	10A	10PCS
DL-16A	139	23	17.7	10.3	12	12	400V	16A	10PCS
DL-20A	155	25	19.2	11.5	13.5	14	400V	20A	10PCS
DL-30A	171	26	20.5	12	14.5	16	400V	30A	10PCS
DL-60A	192	30	26	13.5	16.5	25	400V	60A	10PCS
DL-80A	205	33	27	15	17	35	400V	80A	10PCS
DL-100A	250	46	31	22	21	40	400V	100A	10PCS

